



PANEL SERIES

1278R

MY PLAY GYM



1+
AGES

113
PIECES

10
MODELS



GYM 1-2 P7~P10
SLIDE 1-4 P11~P18



GYM 2



GYM 1

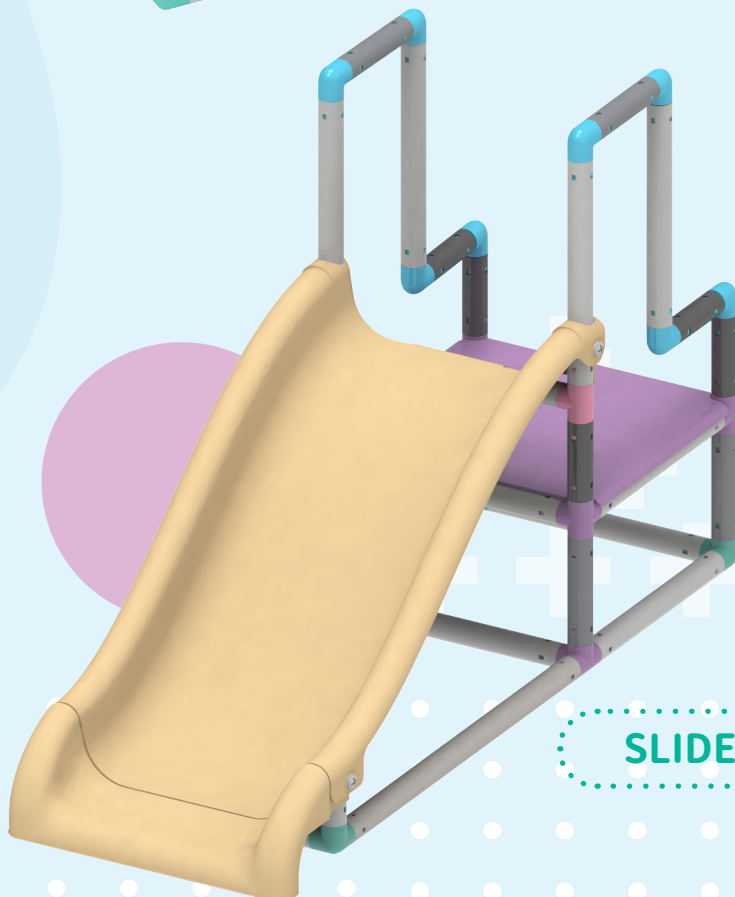

SLIDE 1

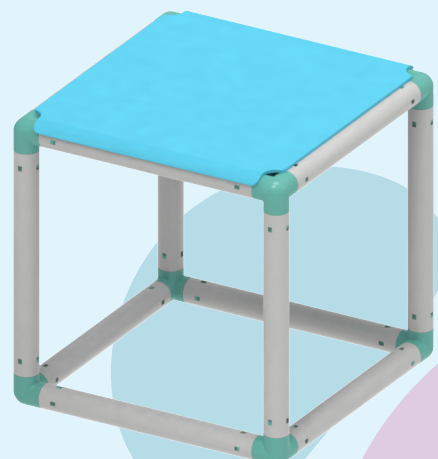



SLIDE 2



SLIDE 3



SLIDE 4



Scan this QR code to view
a video tutorial showing how
to use this product.

FURNITURE 1-4 P19~P26

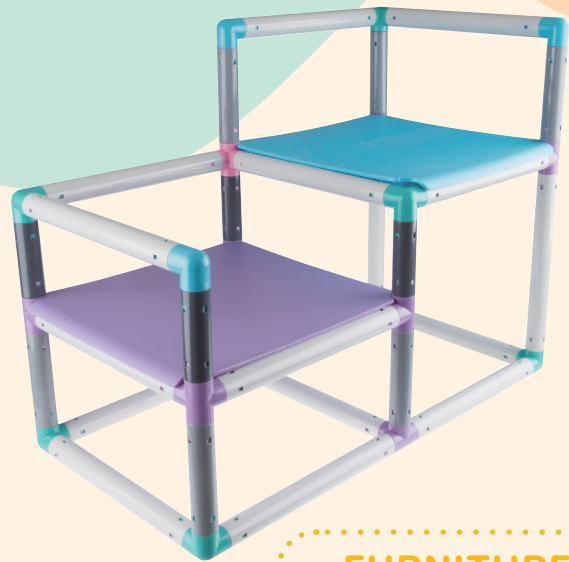

FURNITURE 1



FURNITURE 2



FURNITURE 3



FURNITURE 4



» » » KIT CONTENTS

What's inside your kit:

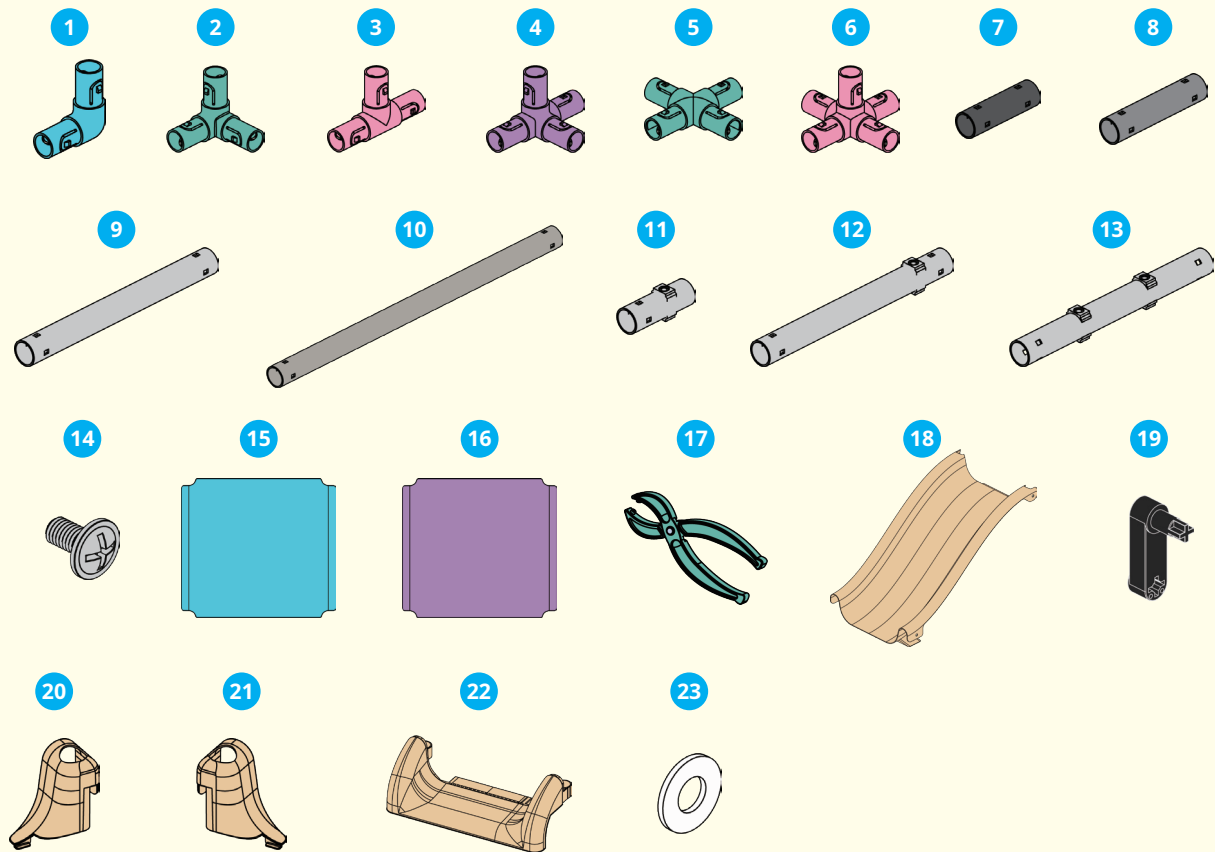

Checklist: Find – Inspect – Check off

No.	Description	ITEM No.	QTY.	No.	Description	ITEM No.	QTY.
1	E-CORNER CONNECTOR	1060-W10-A1B2	8	13	E-300mm DOUBLE LOCKING TUBE	1137-W85-A2S	1
2	E-3-WAY CONNECTOR	1060-W10-B1G	12	14	E-TUBE SCREW	1137-W10-B1SR	6
3	E-T SHAPE CONNECTOR	1060-W10-C1K	4	15	E-SQUARE FLAT II	3599-W10-A1B	1
4	E-4-WAY CONNECTOR	1060-W10-D1P	10	16	E-SQUARE FLAT II	3599-W10-A1P	1
5	E-CROSS CONNECTOR	1136-W10-B1G	1	17	E-RELEASE PLIERS	1060-W85-M1G	2
6	E-5-WAY CONNECTOR	1060-W10-E1K	3	18	E-EXPANDABLE SLIDE	1137-W10-A1Y	1
7	E-105mm TUBE	1060-W17-C5S	8	19	C-CRANK	7063-W10-B3D	2
8	E-143mm TUBE	1060-W17-E8S1	8	20	E-SAFETY COVER R	1137-W10-C2Y	1
9	E-300mm TUBE	1060-W17-C7SR	30	21	E-SAFETY COVER L	1137-W10-C1Y	1
10	E-550mm TUBE	1061-W17-D9S	2	22	E-SLIDE END	1277-W10-A1Y	1
11	E-95mm SINGLE LOCKING TUBE	1137-W85-A4S	2	23	O-SILICONE WASHER M9*17	R12#1277	6
12	E-300mm SINGLE LOCKING TUBE	1137-W85-A1S	2				

» » » ASSEMBLY TIPS

Warning. User Age: 1+
Warning. User Weight: 20kgs max
Warning. Outdoor use / Indoor use

IMPORTANT:

This set is intended for adult assembly only.
Please read all instructions carefully before beginning.

1. Keep unused parts in the marked bag(s) until required. Some parts appear similar and may be confused.
2. Assemble each section separately - as shown in the exploded diagrams.
3. If parts need to be loosened, use the included "RELEASE PLIERS" to assist you.
4. After each section is complete, assemble the completed sections together into the final unit.

ASSEMBLY & DISASSEMBLY

How to Assemble & Disassemble Tubes and Connectors.

Note: Do not hold a tube or connector where the insertion takes place, fingers may be pinched.

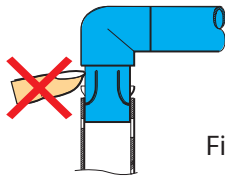

Fig. 1

- (1) Push the corner connector onto the tube and twist the tube until a "click" is heard.

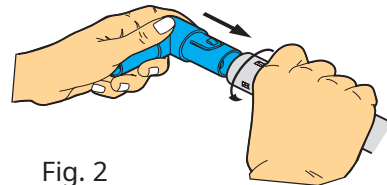

Fig. 2

- (2) Finish the assembly of both connectors with the tube in between. Then insert the connectors into two separate tubes to complete a panel.(Fig. 3-1) Do not assemble the tubes and connectors one by one. (Fig. 3-2)

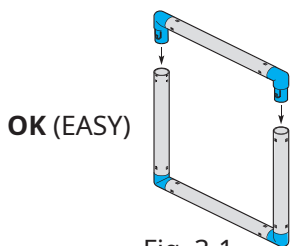

Fig. 3-1

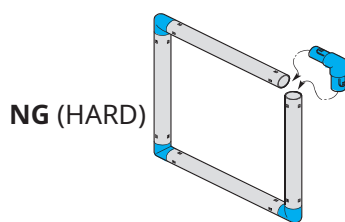

Fig. 3-2

- (3) Position the RELEASE PLIER nodes over the holes where the safety lock pins are visible. Squeeze gently to release the tube from the connector.

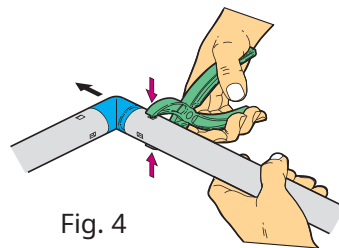

Fig. 4

How to Fix Square Flat onto Tube Frame

- (1) Insert and fix the tubes on the back of the SQUARE FLAT, and then connect the connectors as Fig. 5-1 shows.

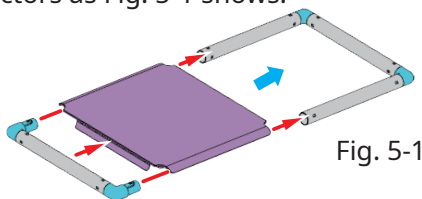

Fig. 5-1

- (2)When assembling two SQUARE FLAT, the two flat sides should be placed together (Fig. 5-2).

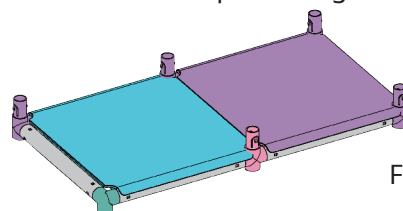

Fig. 5-2

- (3) Warning: Keep fingers clear of the gap between the SQUARE FLATS and tubes when they are being connected. (Fig. 5-3)

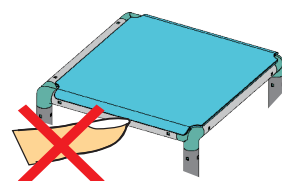

Fig. 5-3

› › › ASSEMBLY TIPS

How to Fasten the Slide

(1) Once the model is constructed, secure the ends of the slide to the tubes using the TUBE SCREWS and CRANK or double CRANK as shown (Figs. 7-1 & 7-2).

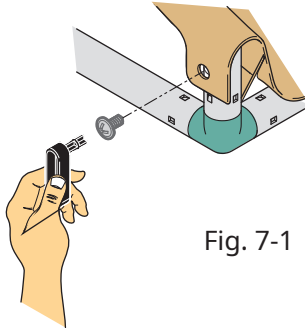

Fig. 7-1

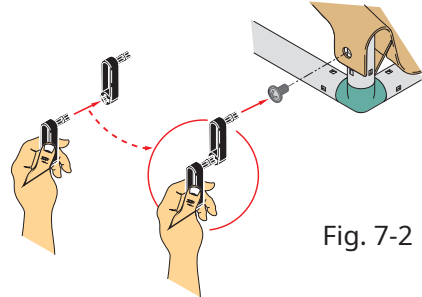
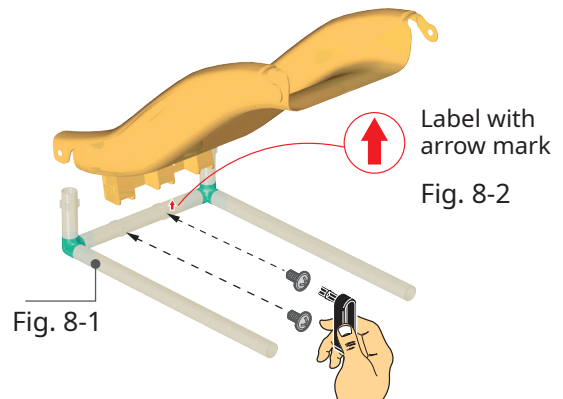

Fig. 7-2

(2) The 300mm DOUBLE LOCKING TUBE is used to hold the bottom of the slide. TUBE SCREWS are fixed in a pre-defined and specific angle. If the slide or tube are not positioned correctly, the fixings will not be secure. Ensure the 300mm DOUBLE LOCKING TUBE is positioned correctly (Fig. 8-1).

- The 300mm DOUBLE LOCKING TUBE must be placed so that the arrow mark on the label faces upward when viewed from inside the model (Fig. 8-2).
- Fasten the 300mm DOUBLE LOCKING TUBE to the bottom of the slide with 2 TUBE SCREWS and the double CRANK.



Safety Notice

Parents or guardians must read the instruction manual and the following notice carefully before use in order to ensure safe use. Please retain these instructions for future reference.

1. Notes for assembly and placement

- Parents or guardians must read the instruction manual carefully in full and follow the instructions provided.
- During assembly keep small parts away from young children to avoid possible ingestion.
- These gyms are designed specifically for outdoor/indoor use and must be placed on a flat surface.
- Do not place the unit near a stove or fire.

2. Notice for use

- To be used only under parental or guardian's supervision.
- Inspect tubes, connectors and fixtures periodically to ensure safe use.
- Only use the gym when the structure is stable.
- To avoid the risk of slipping use bare feet.
- Don't jump over the slide, or from high positions to the floor.
- Avoid pushing, shoving and rough play while using the equipment.
- Do not allow two or more children to sit or stand on the same tube at the same time.
- This slide is designed for young children, aged one to five years only; children above this age should not use the equipment.

GYM 1

Order of assembly

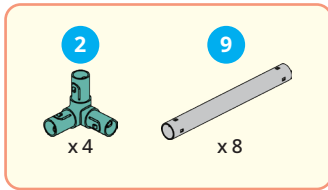

1

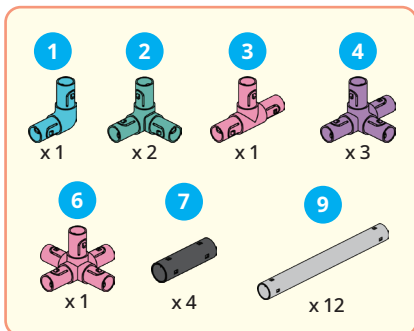
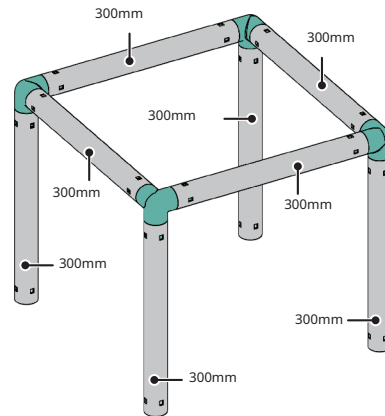

2

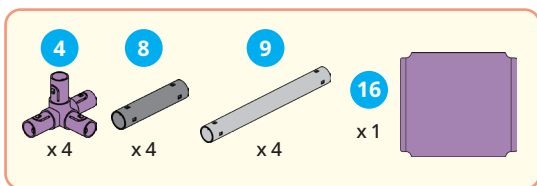
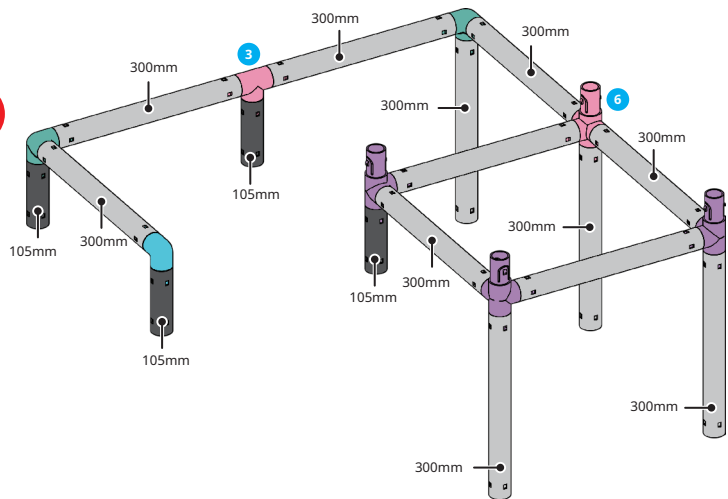

3

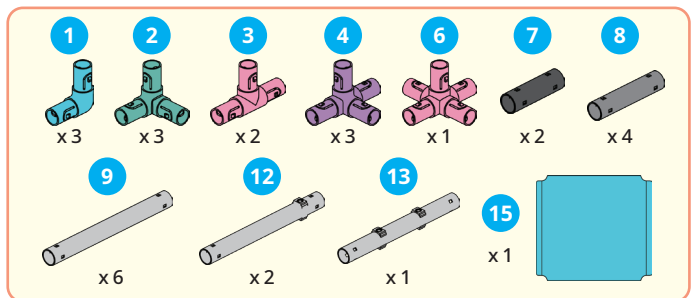
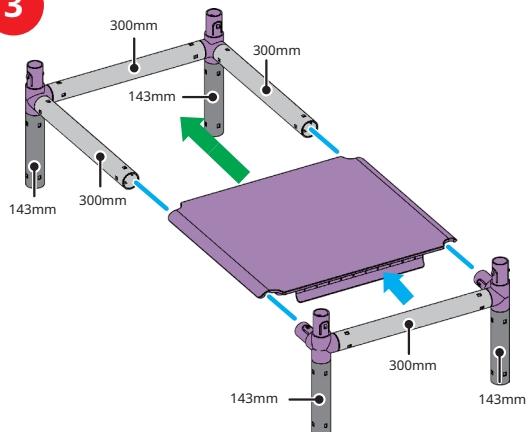

4

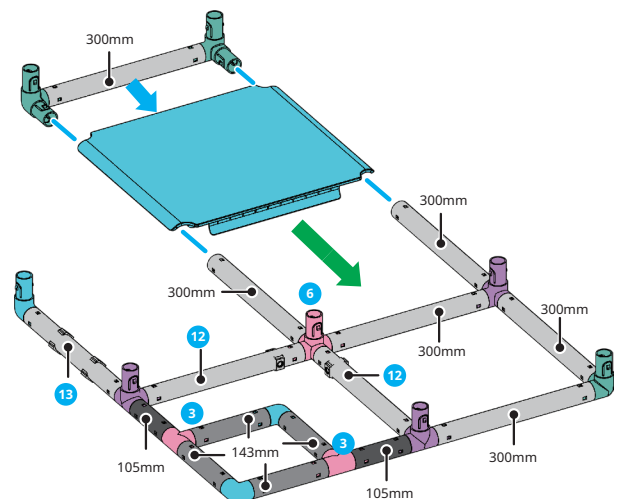

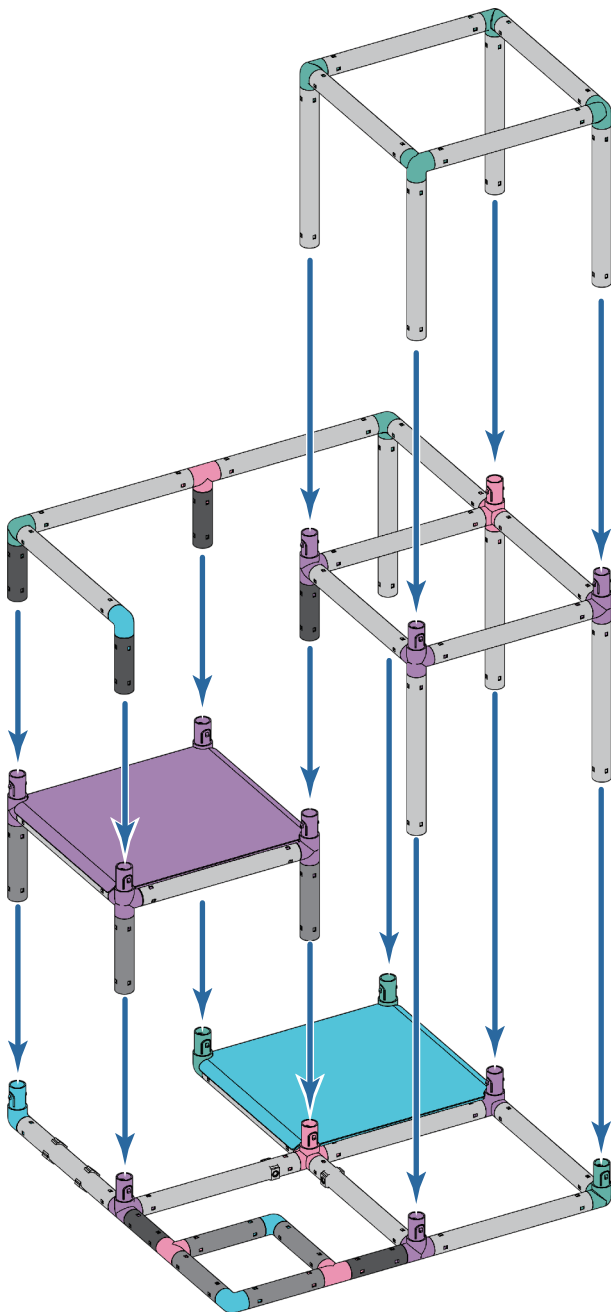

- 1
- 2
- 3
- 4

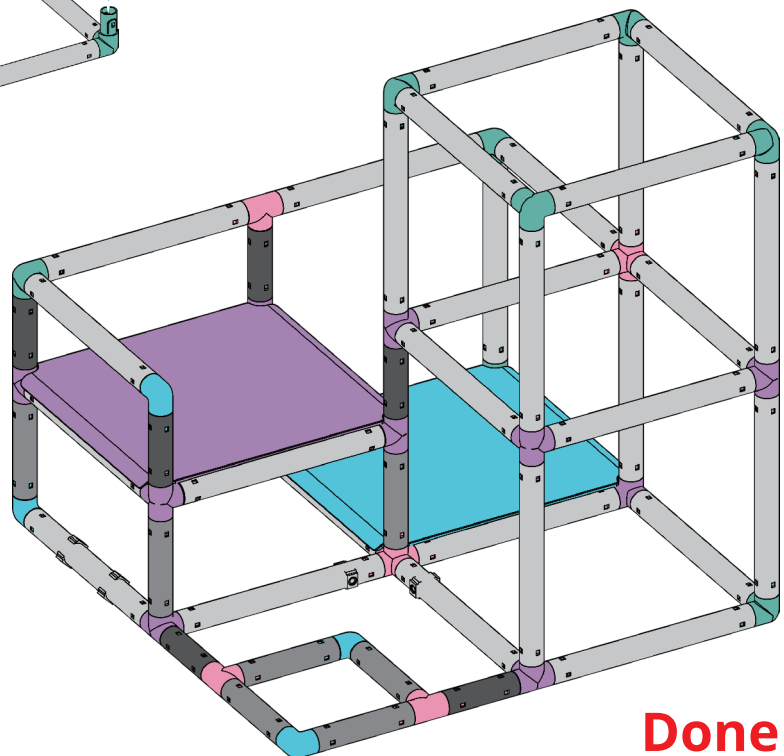

Done

GYM 2

Order of assembly

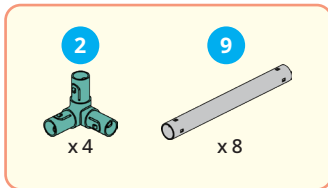

1

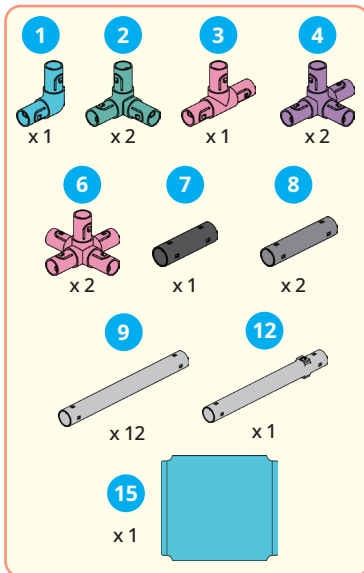
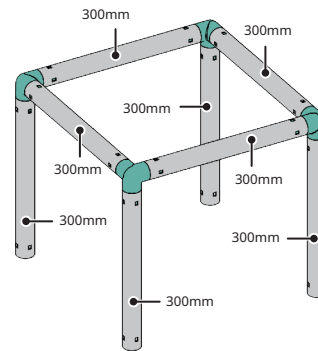

2

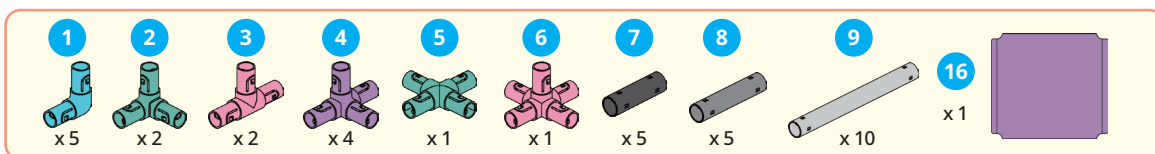
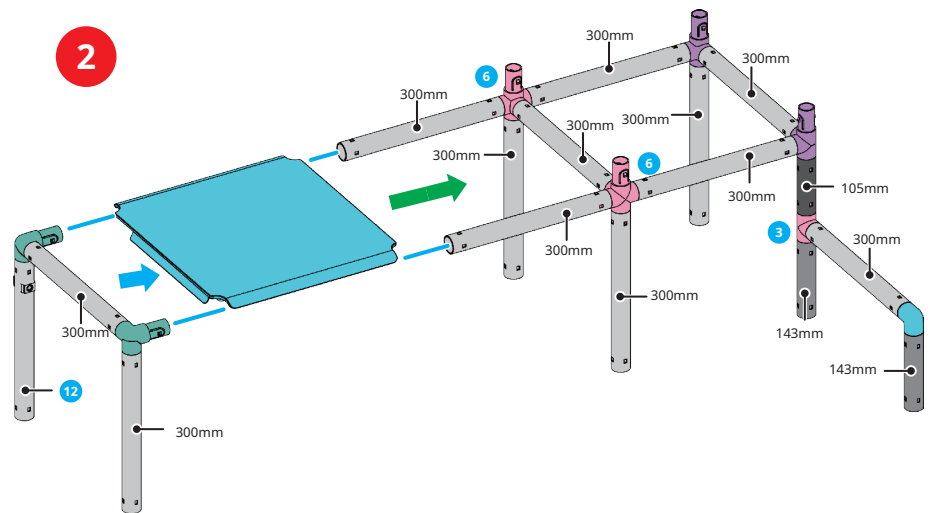

3

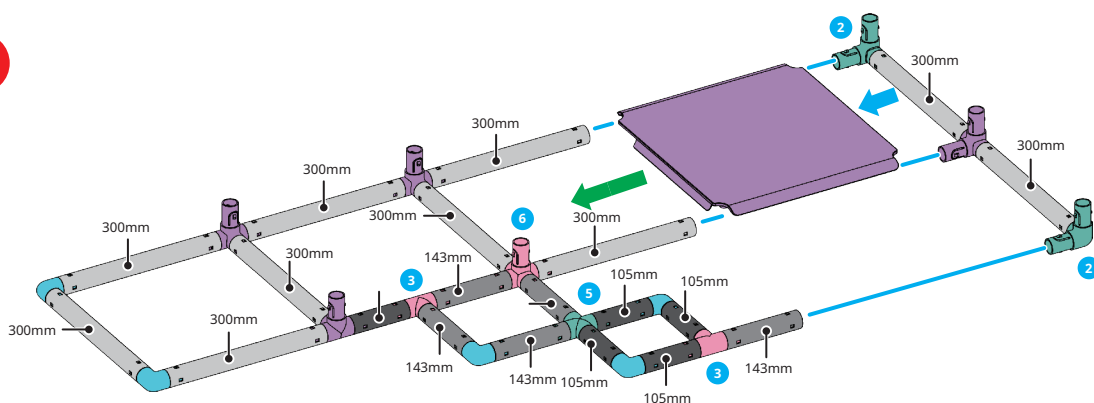

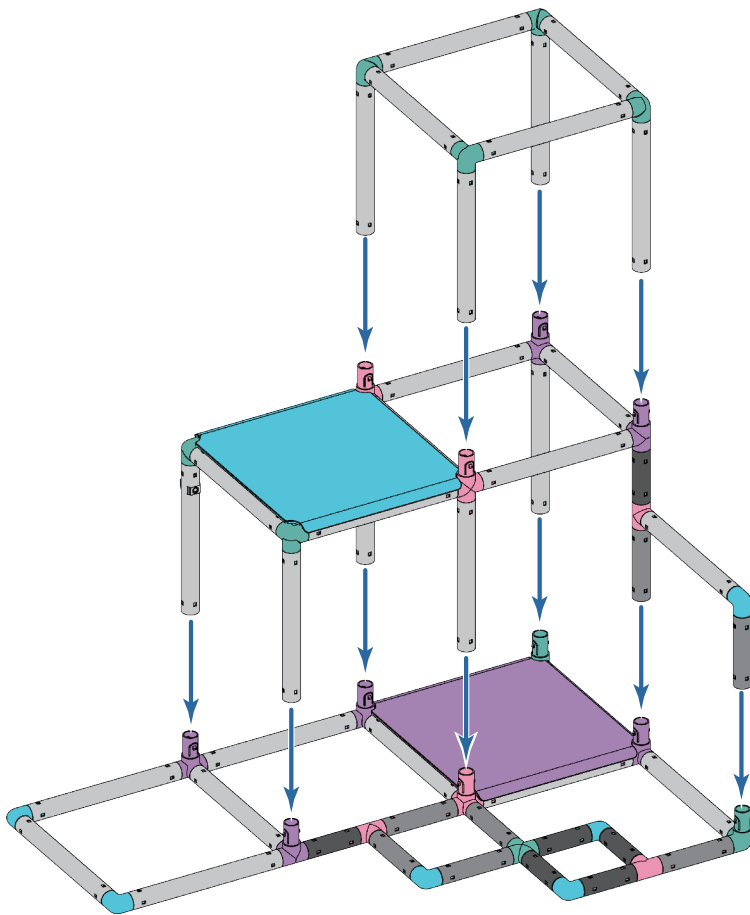

- 1
- 2
- 3

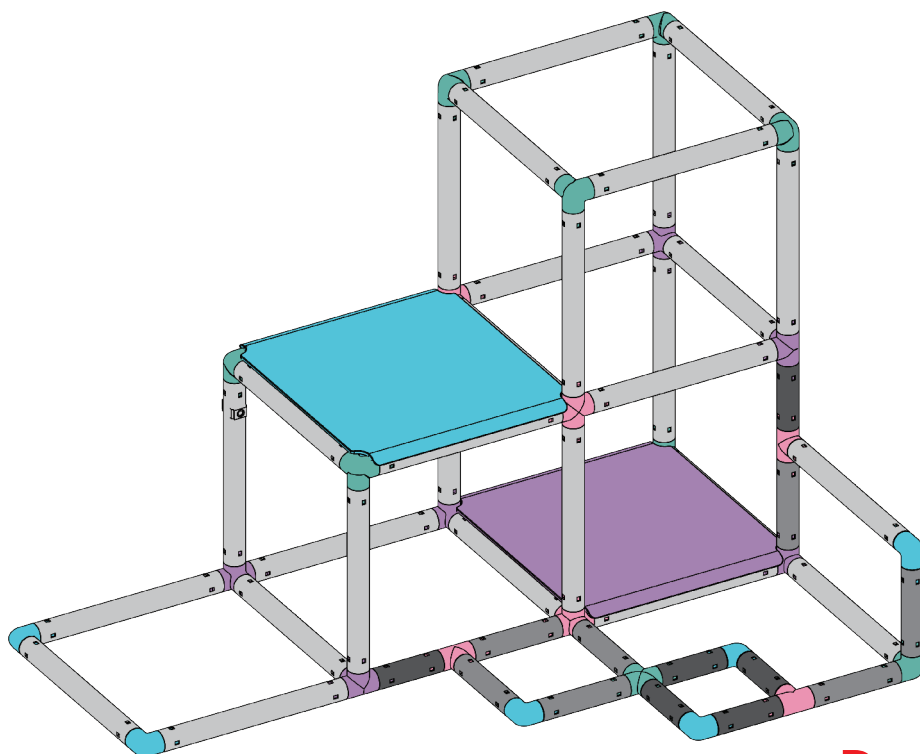

Done

SLIDE 1

Order of assembly

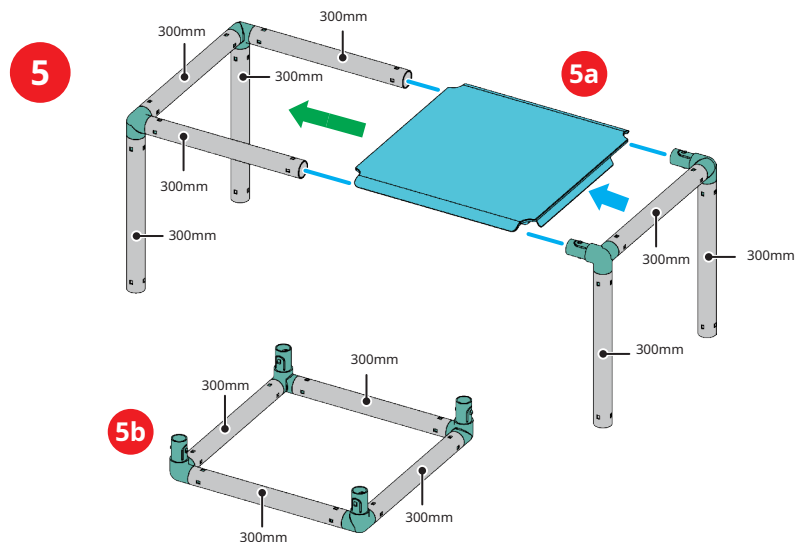
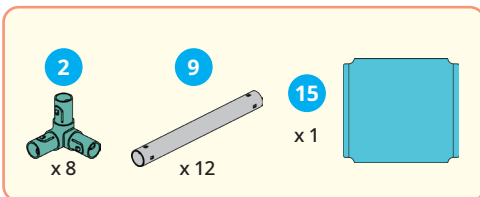
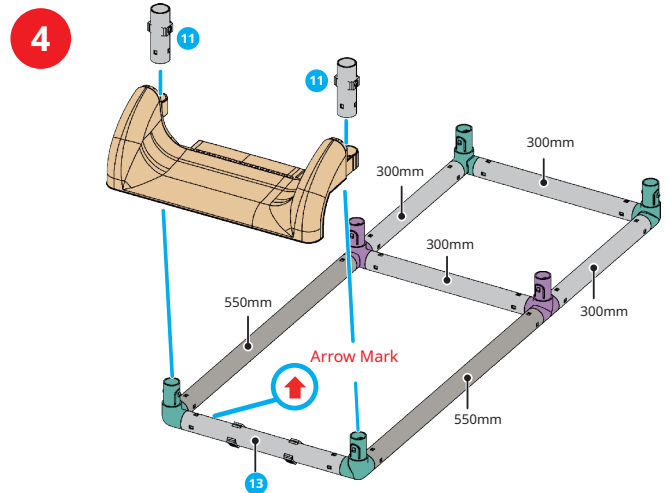
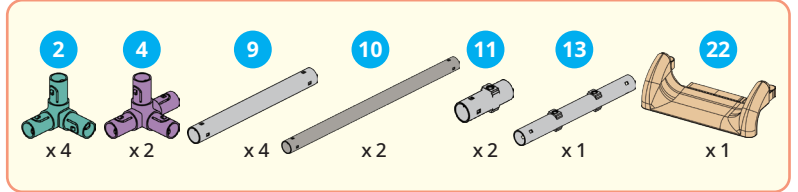
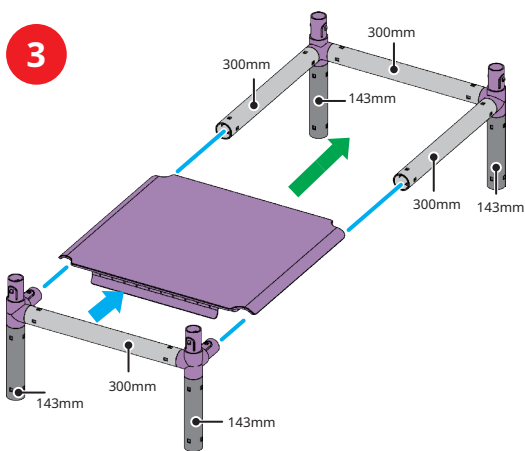
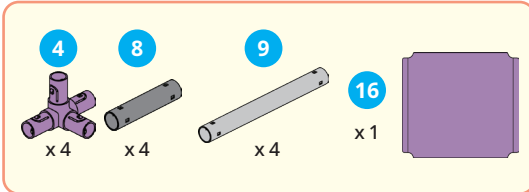
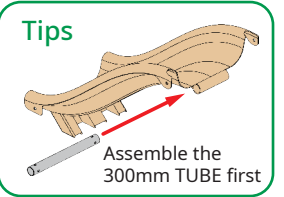
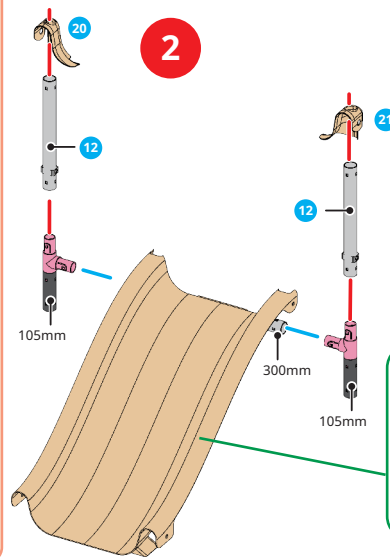
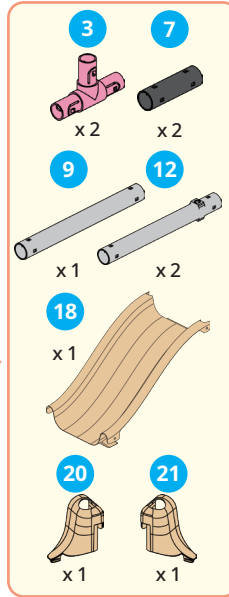
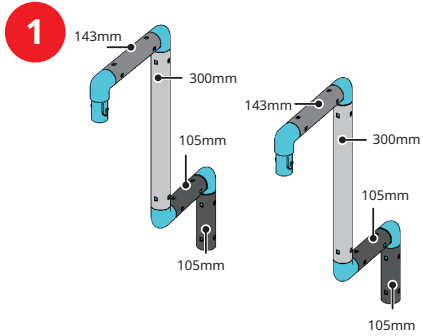
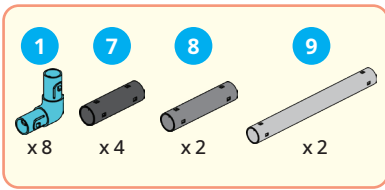

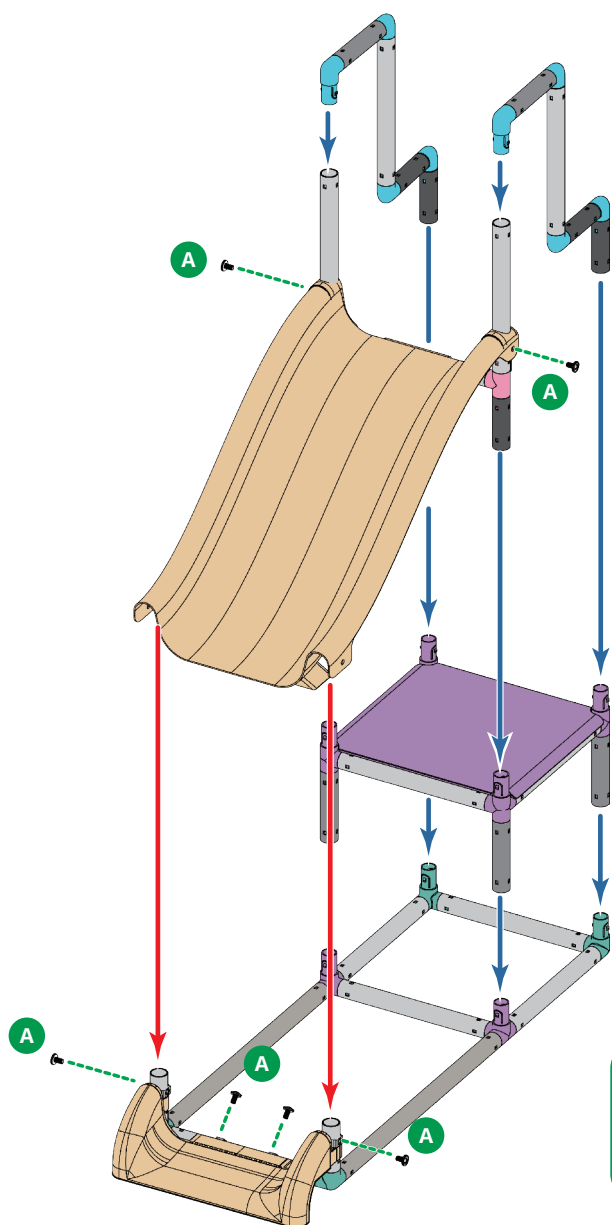

1



2



3



4

A x6

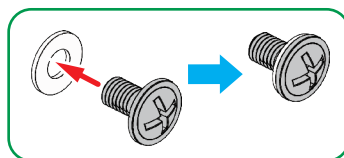

5

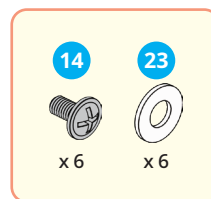
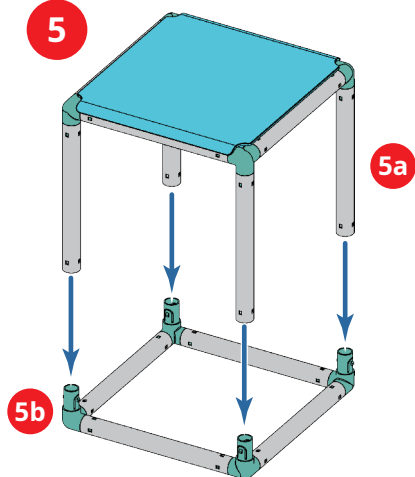

1. Assemble the slide first
2. Put washers on all screws
3. Lock screws

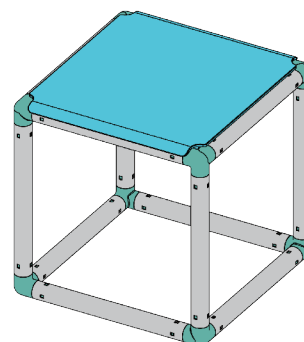
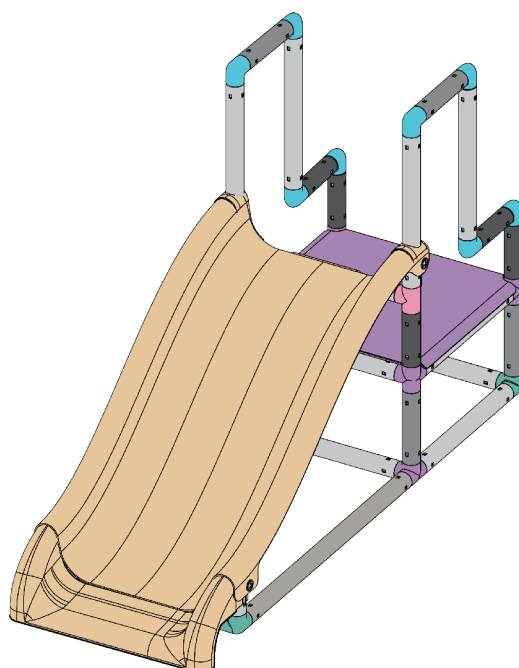

Done

SLIDE 2

Order of assembly

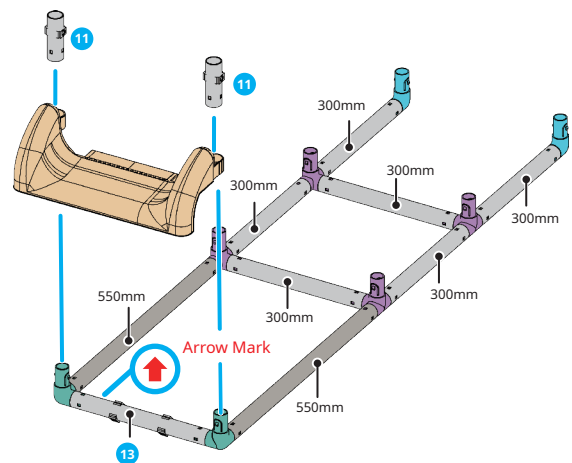
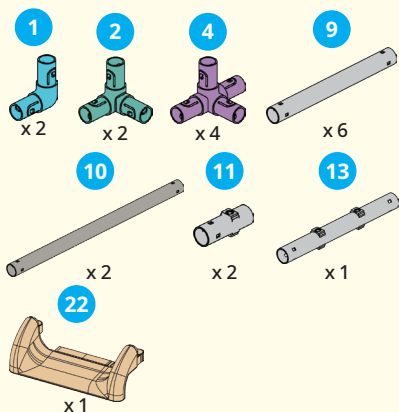
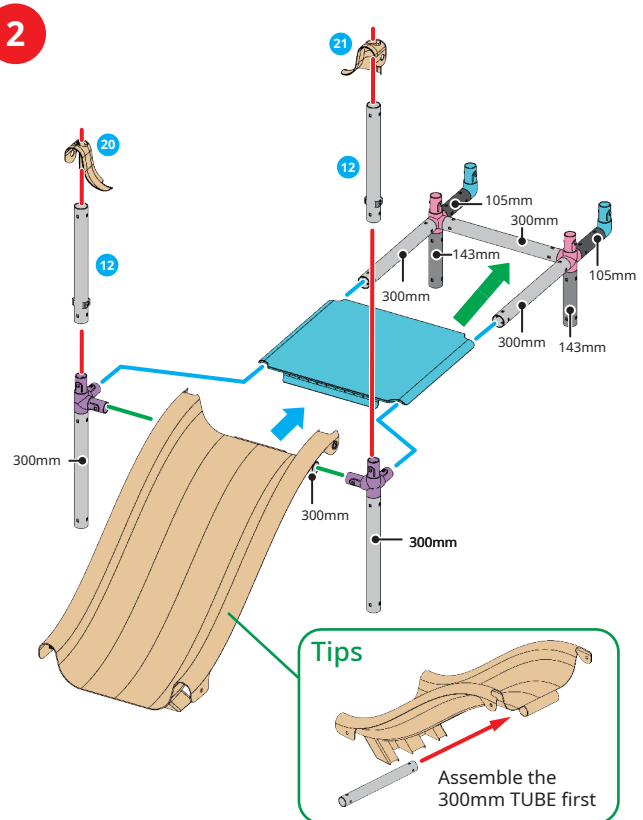
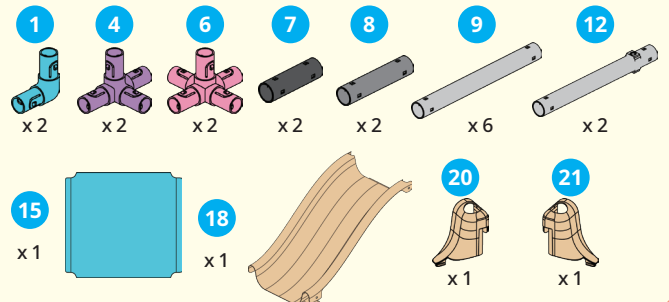
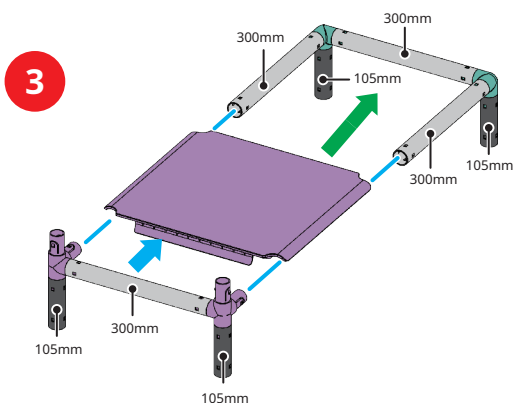
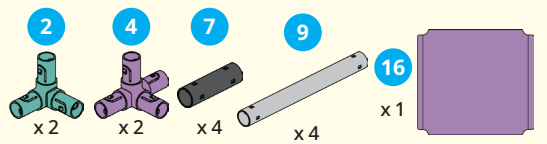
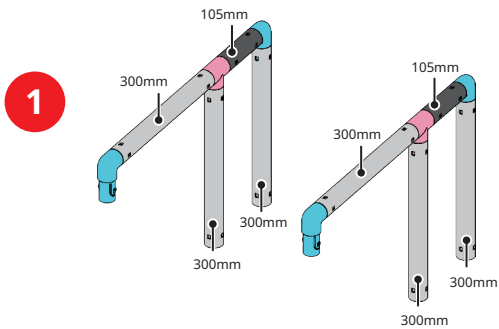
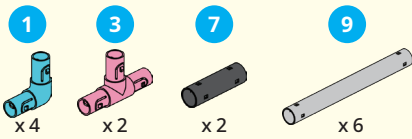

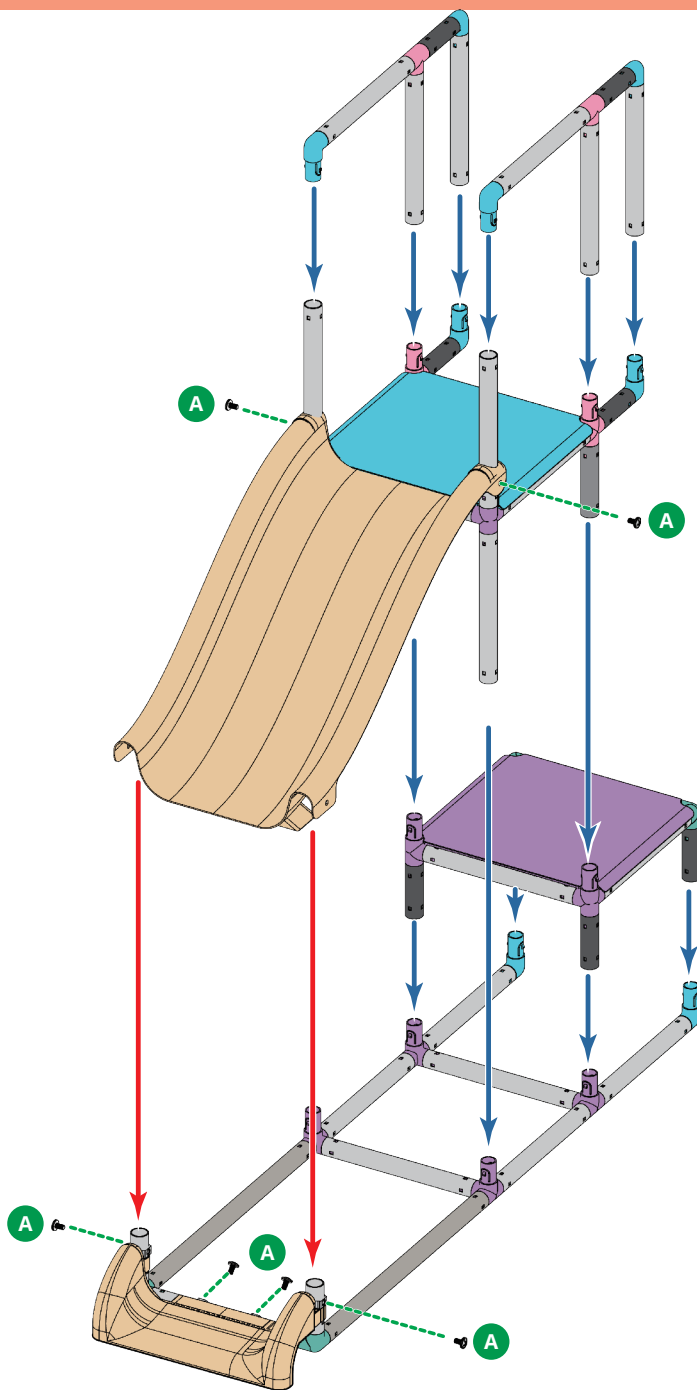

1



2



3



4

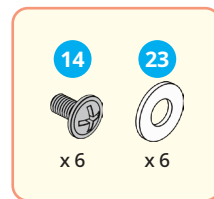

A x6

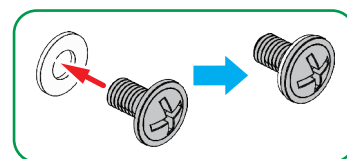

1. Assemble the slide first
2. Put washers on all screws
3. Lock screws

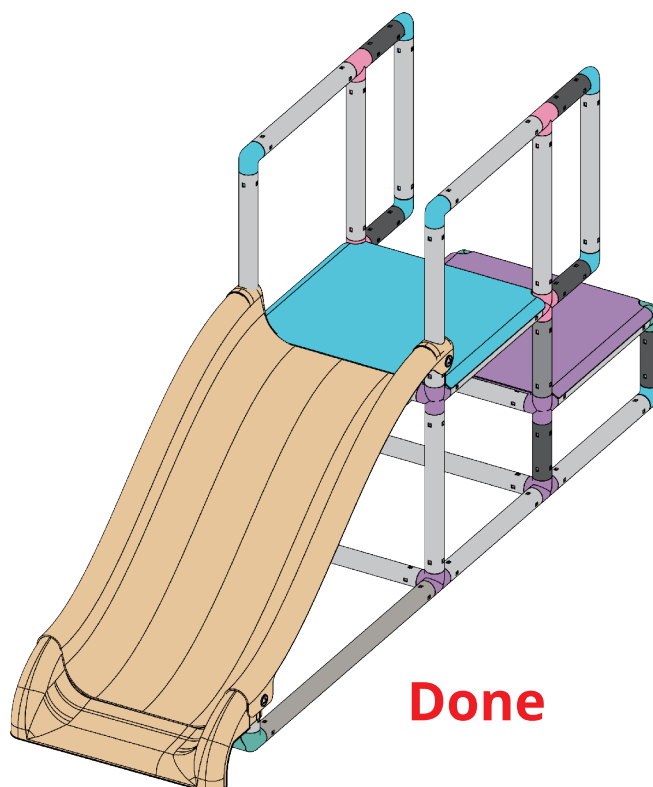

Done

SLIDE 3

Order of assembly

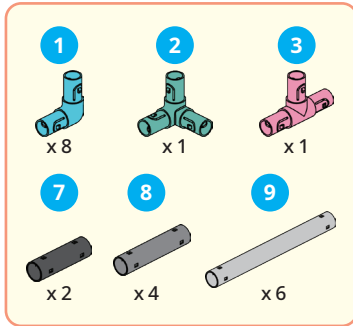

1

1a

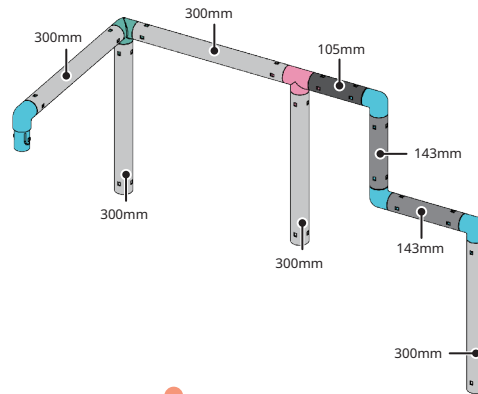

1b

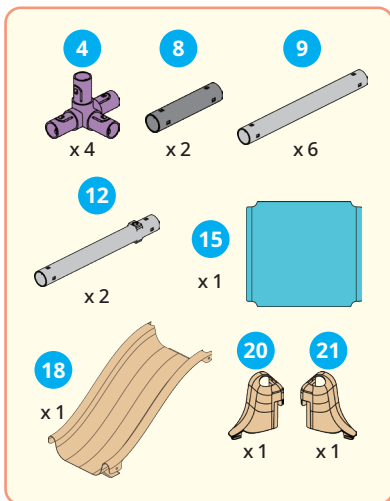
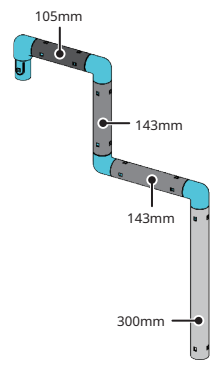

2

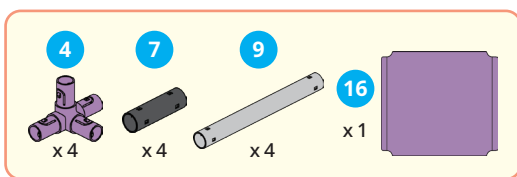
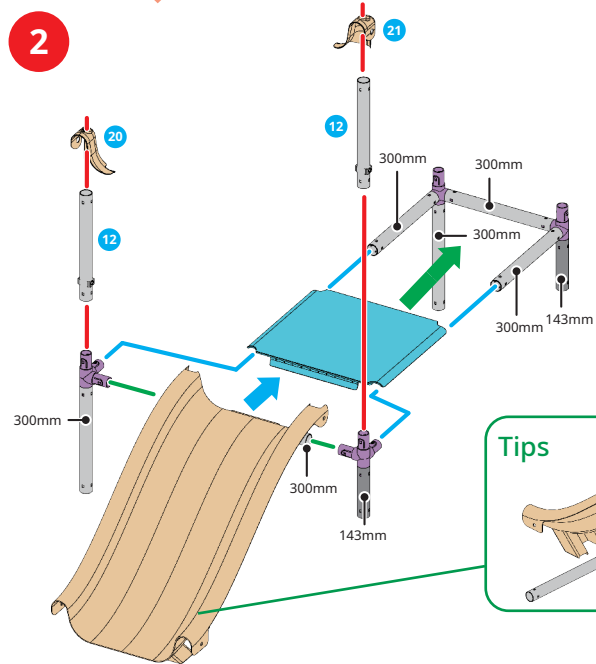

3

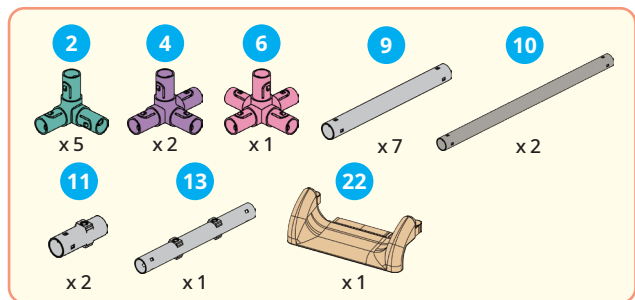
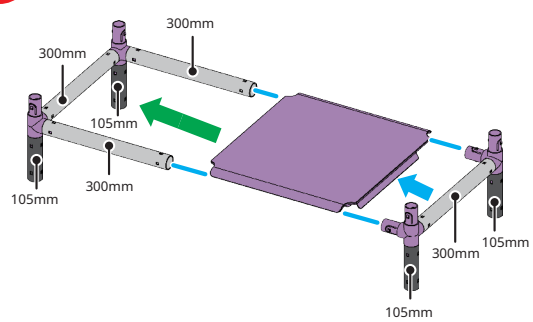

4

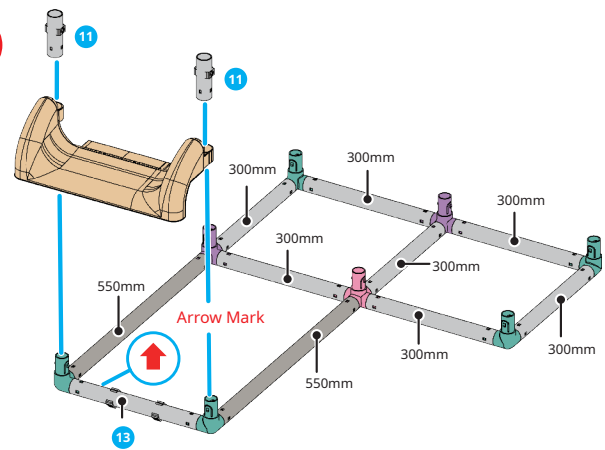

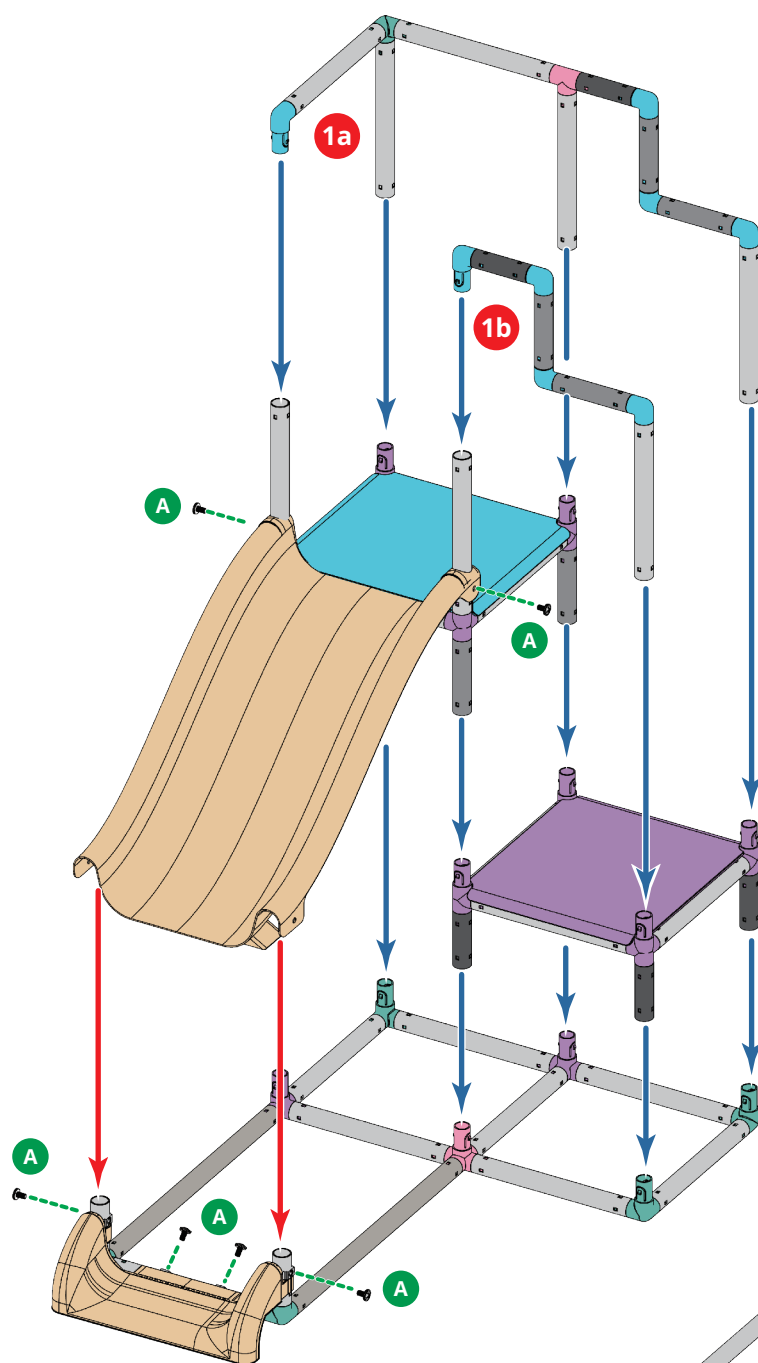

1



2



3



4

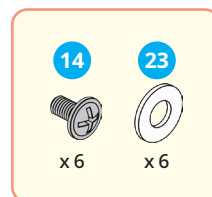

A x6

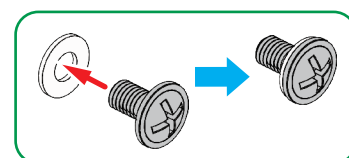

1. Assemble the slide first
2. Put washers on all screws
3. Lock screws

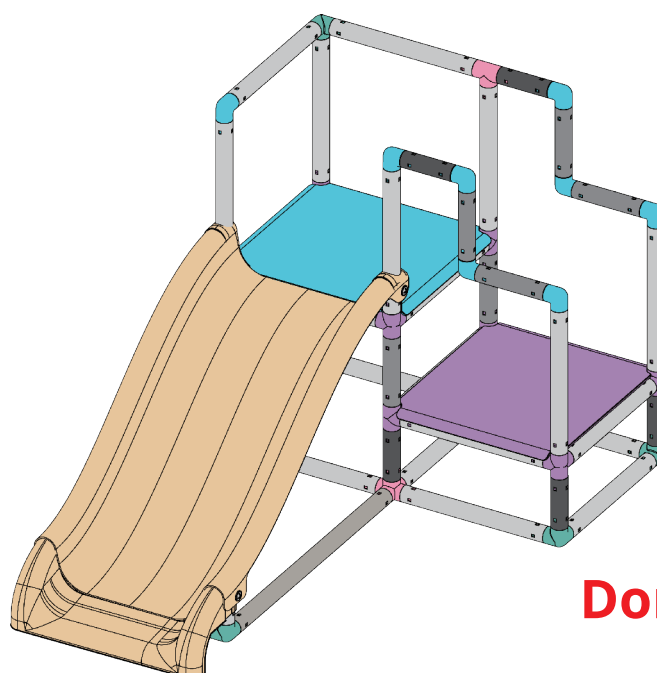

Done

SLIDE 4

Order of assembly

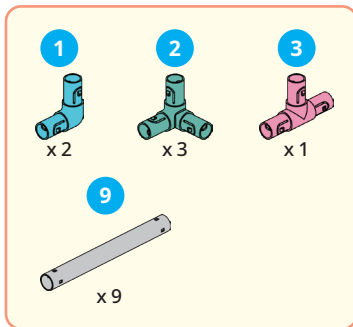

1

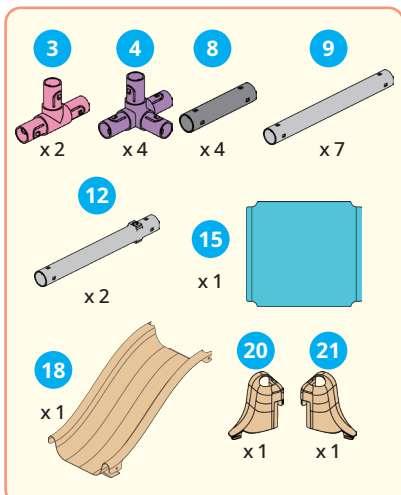
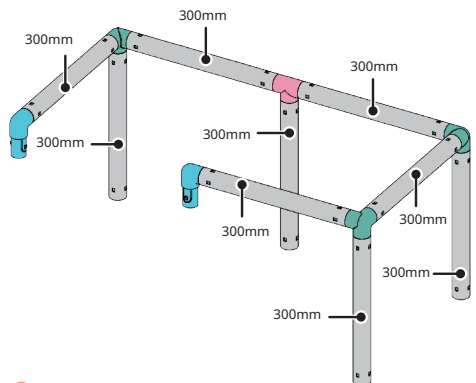

2

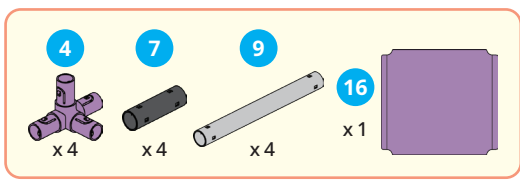
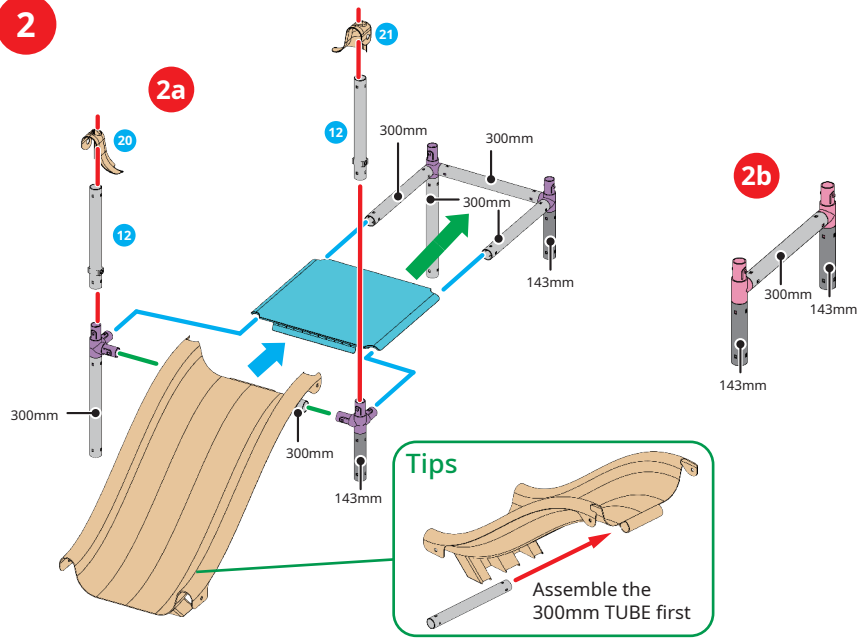

3

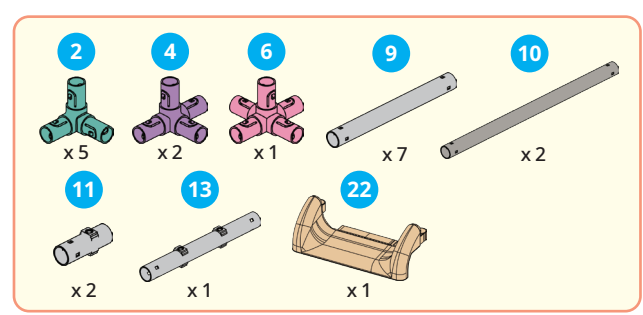
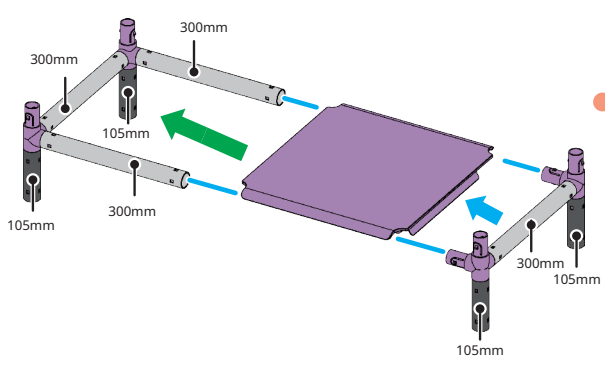

4

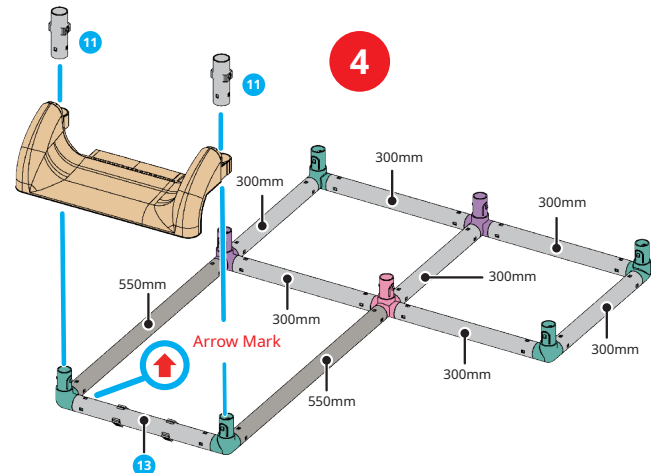

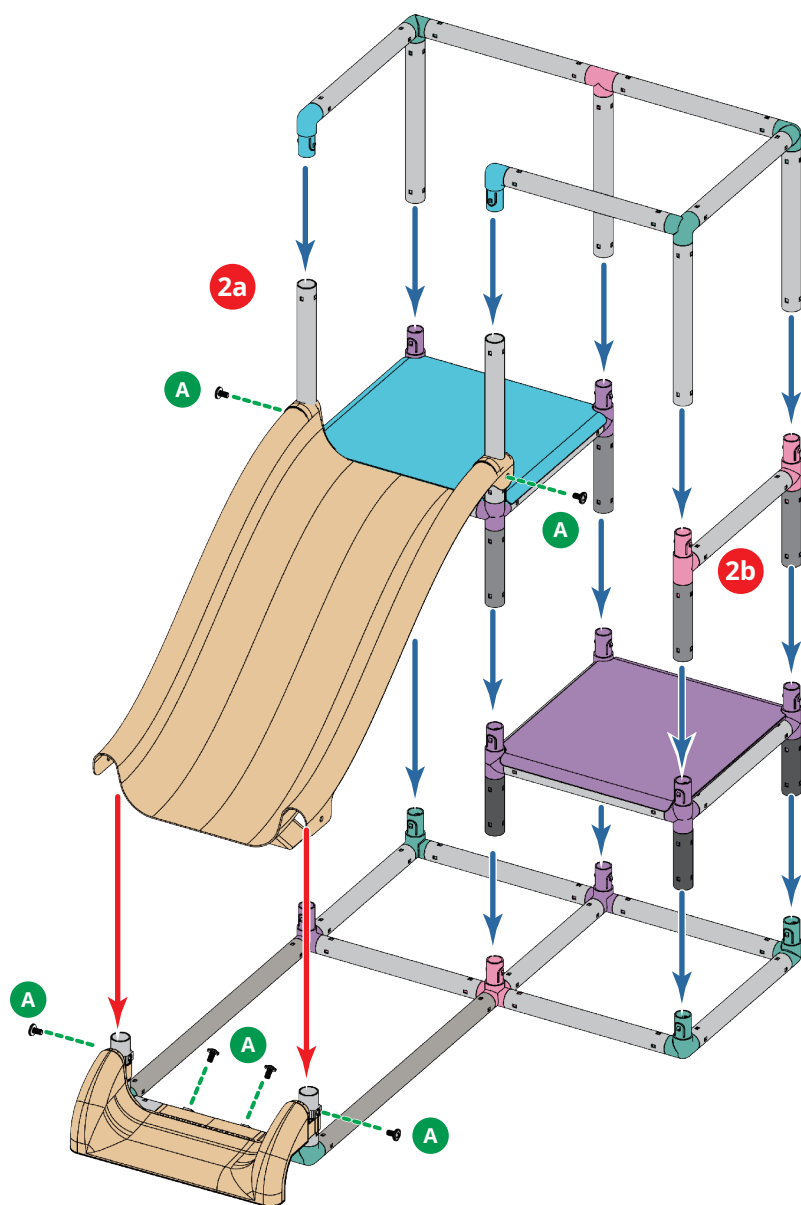

1



2



3



4

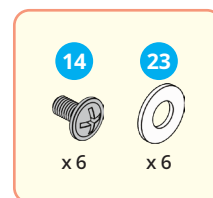

A x6

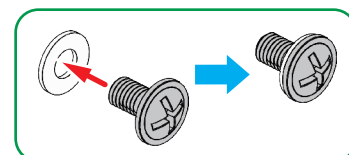

1. Assemble the slide first
2. Put washers on all screws
3. Lock screws

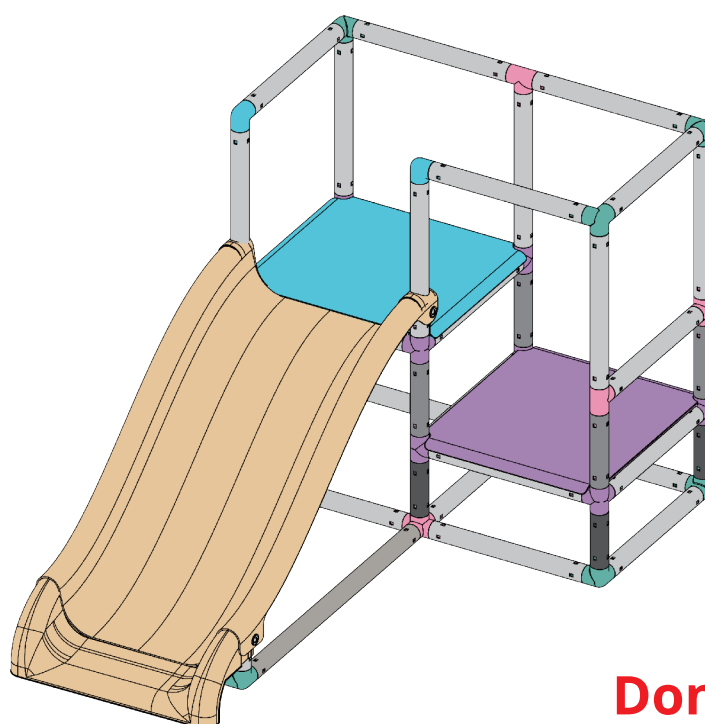

Done

FURNITURE 1

Order of assembly

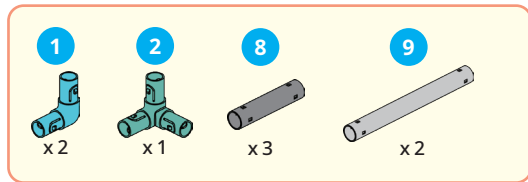

1

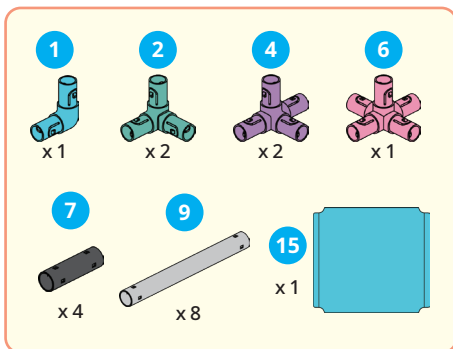
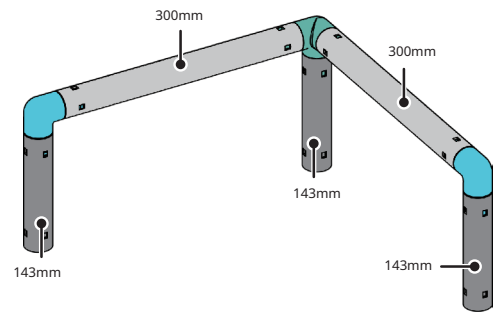

2

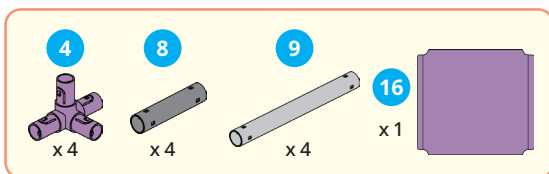
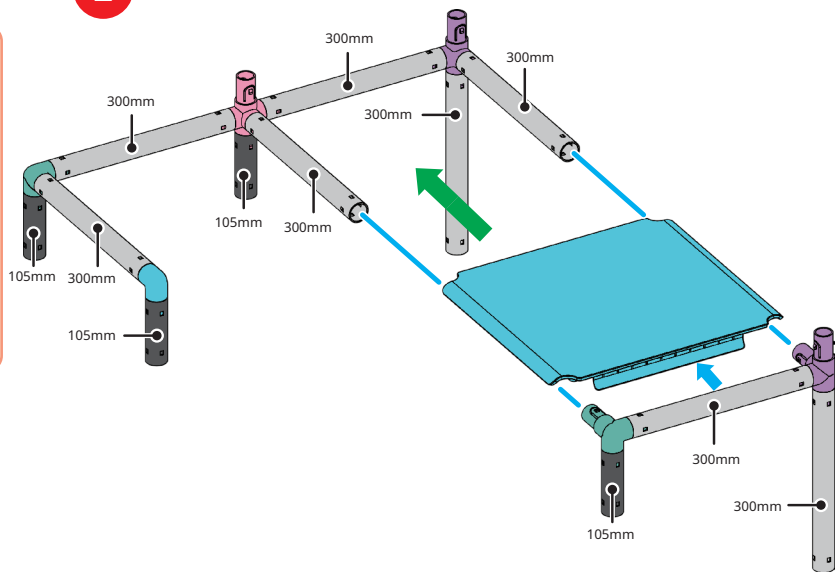

3

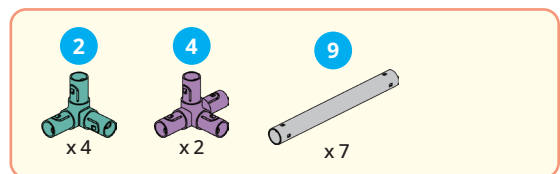
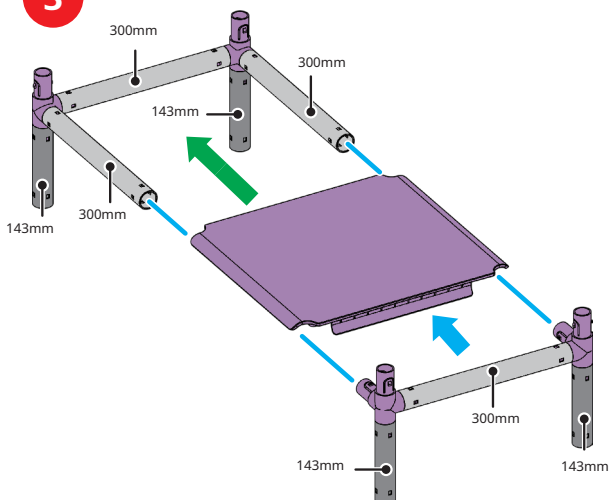

4

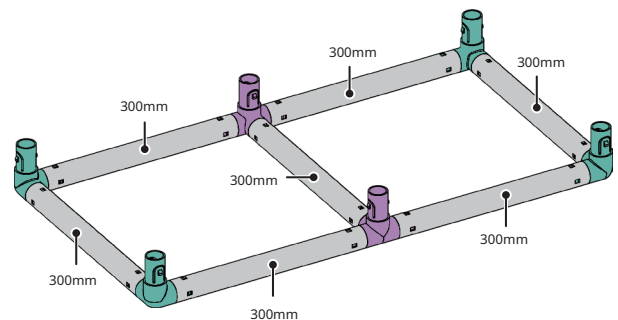

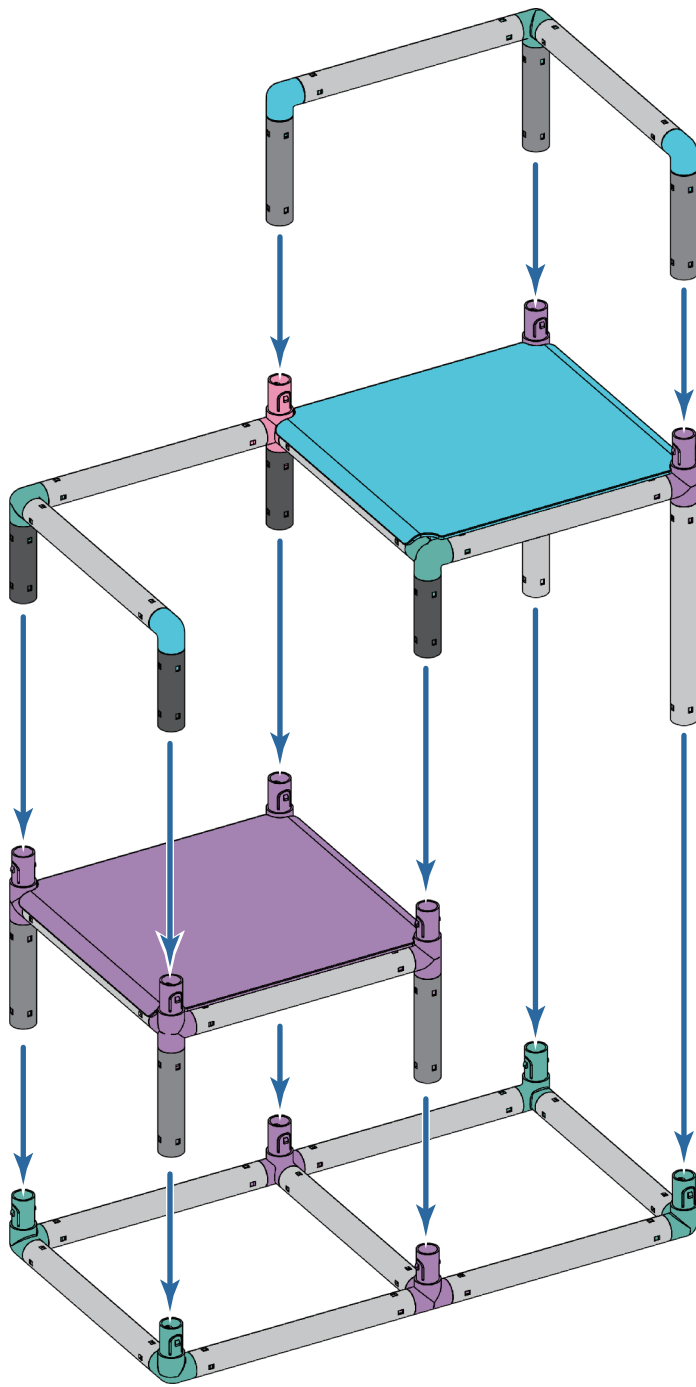

- 1
- 2
- 3
- 4

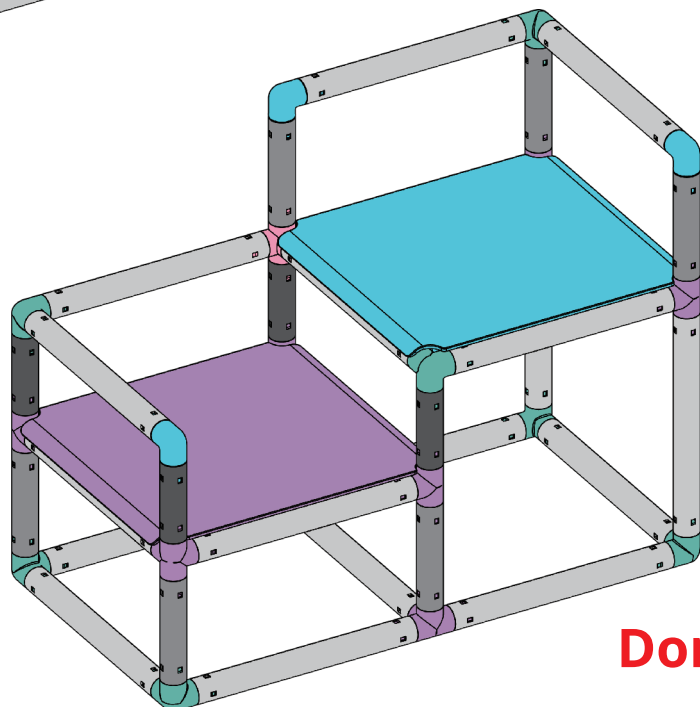

Done

FURNITURE 2

Order of assembly



1

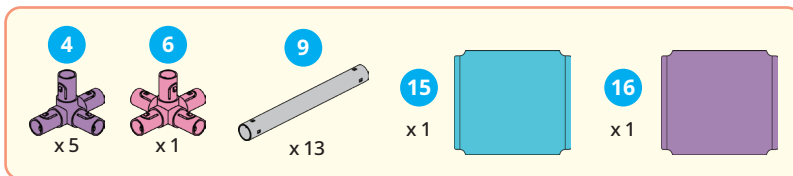
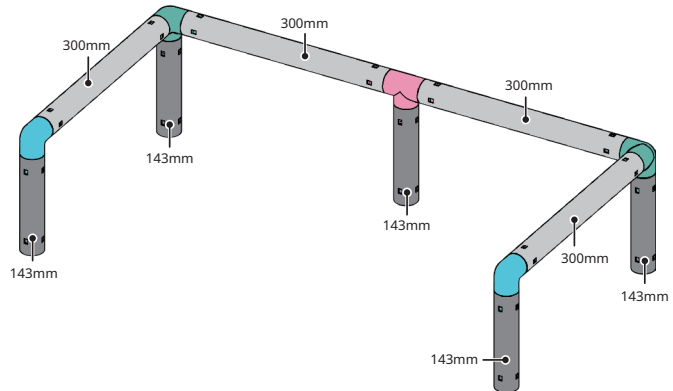
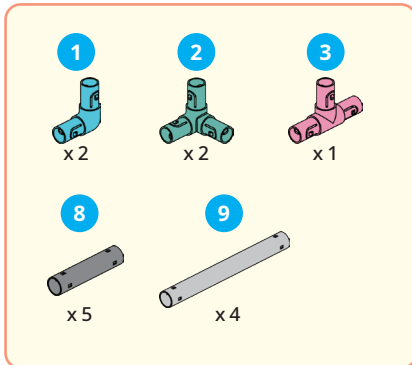

2

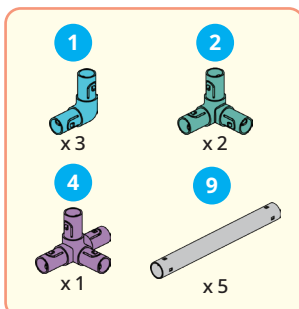
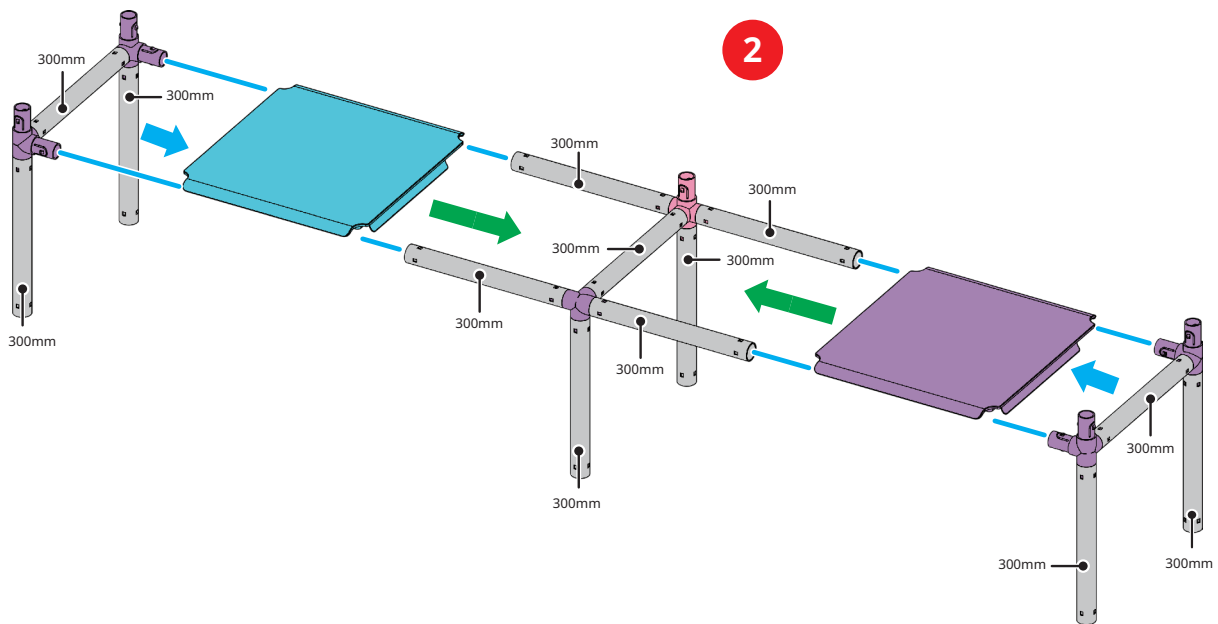

3

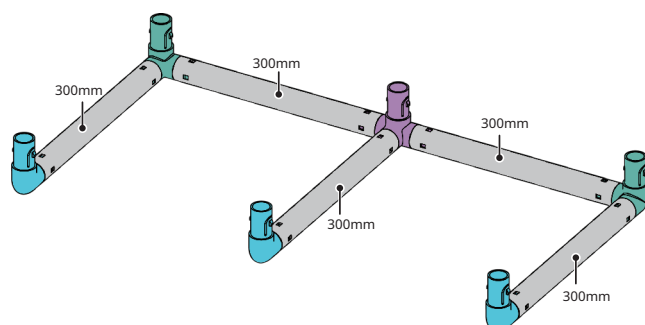

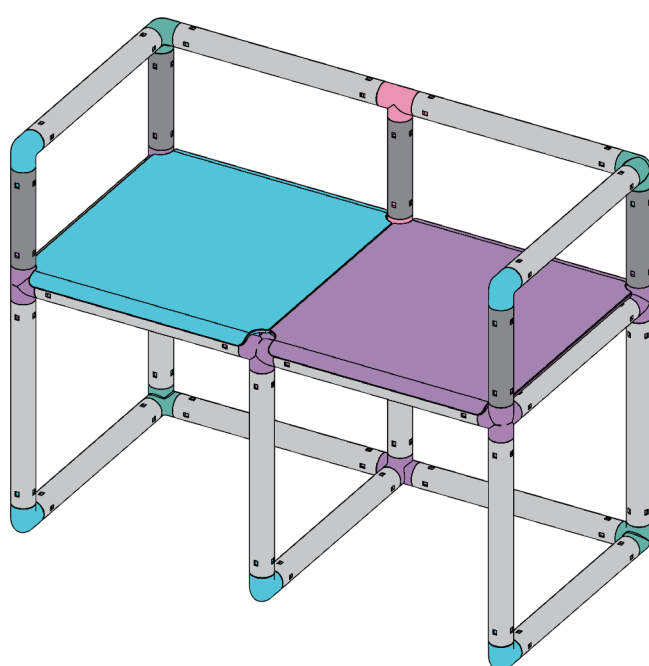
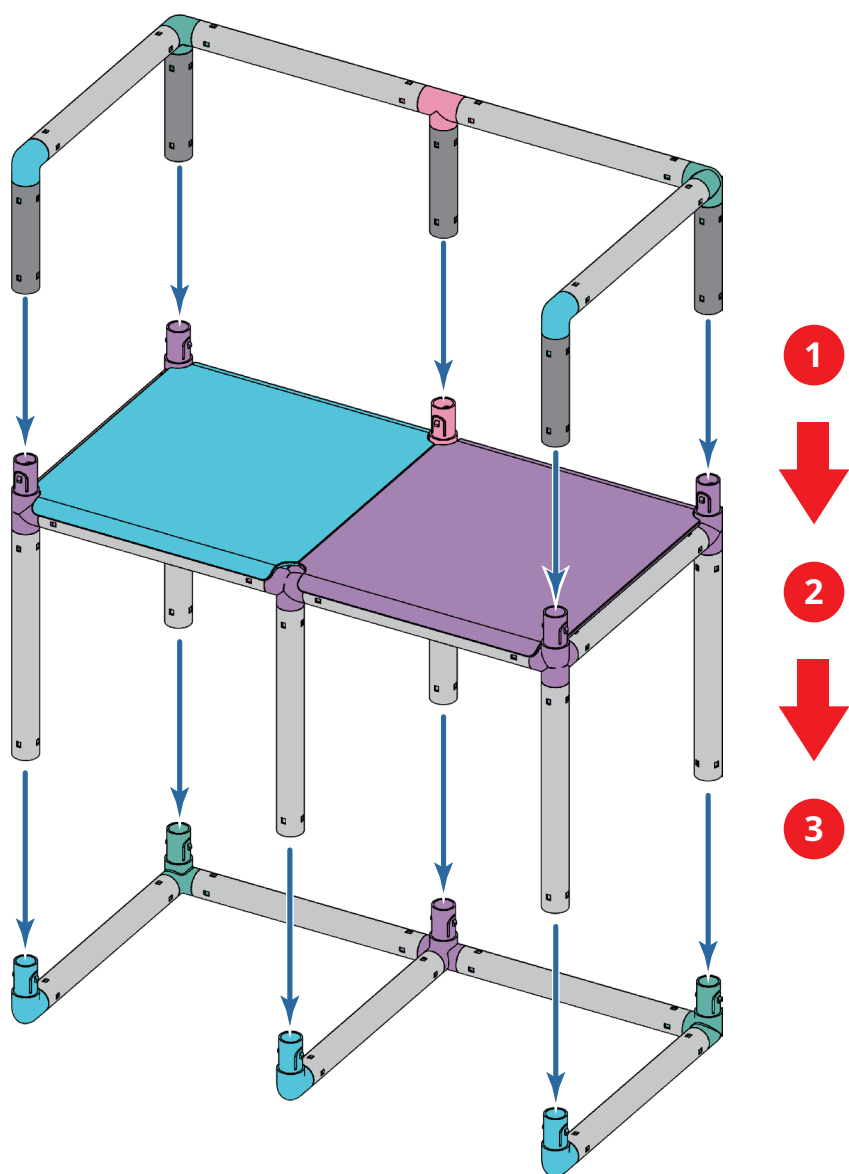

Done

FURNITURE 3

Order of assembly

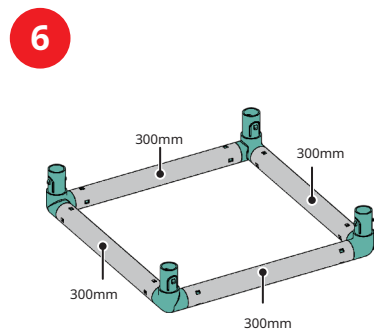
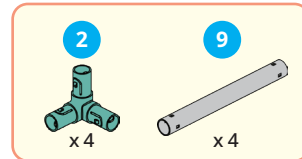
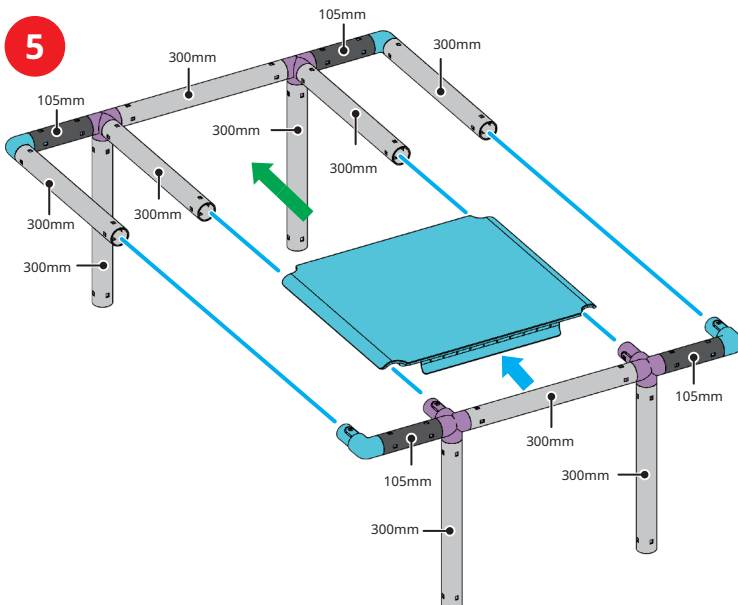
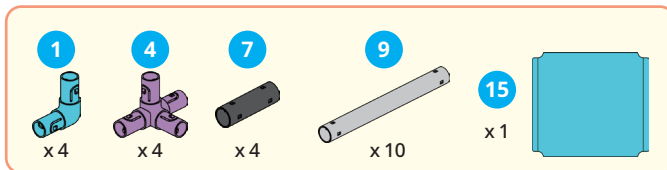
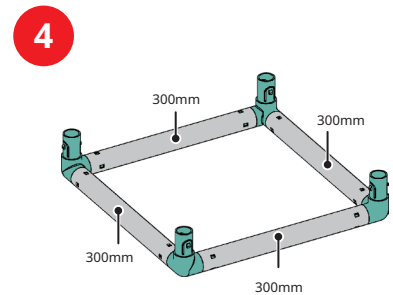
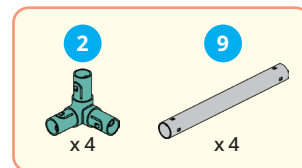
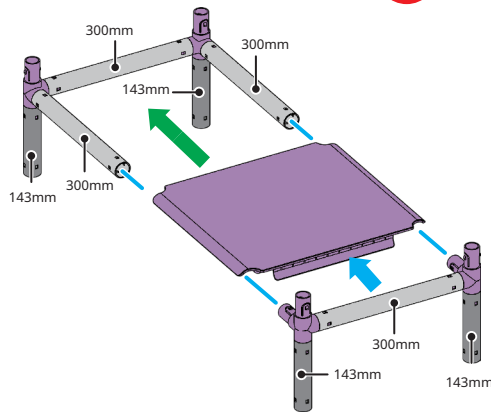
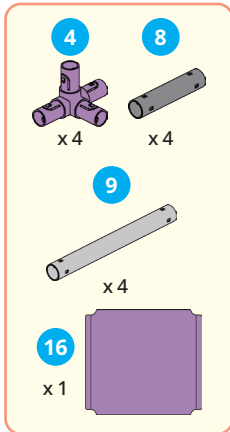
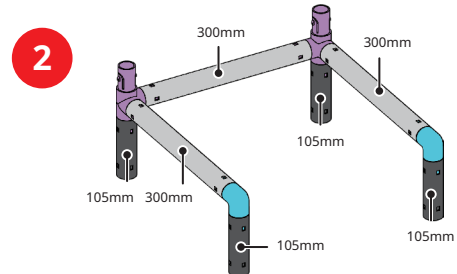
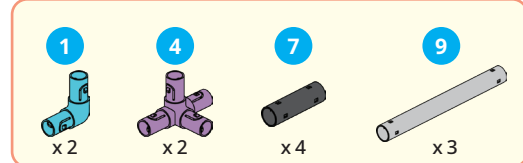
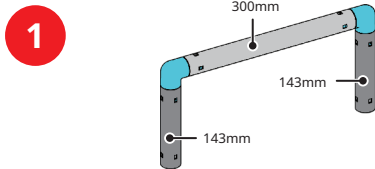
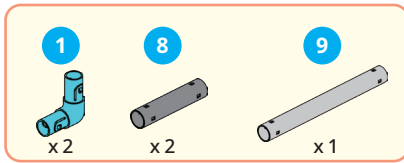

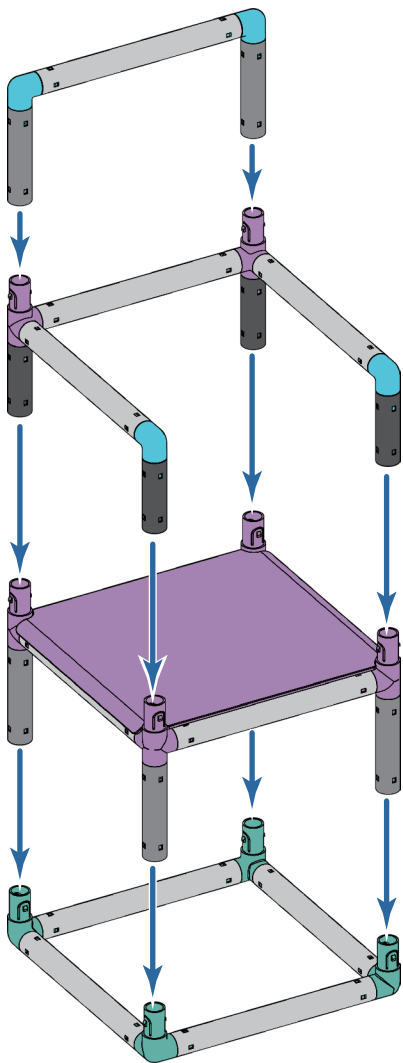

- 1
- 2
- 3
- 4

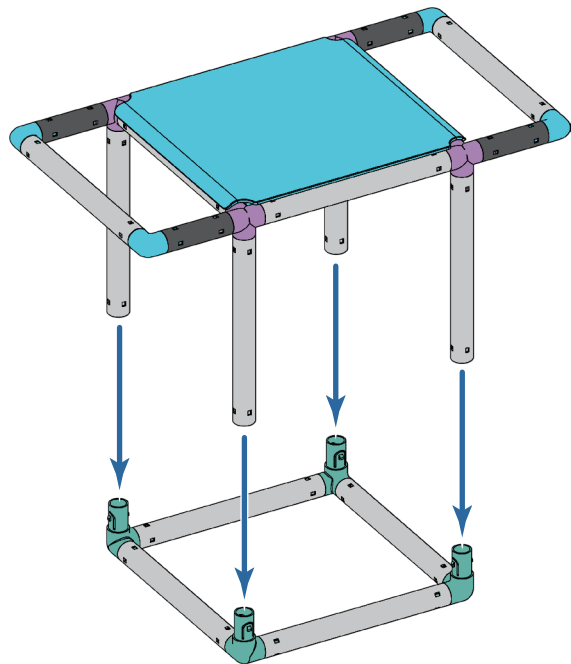

- 5
- 6

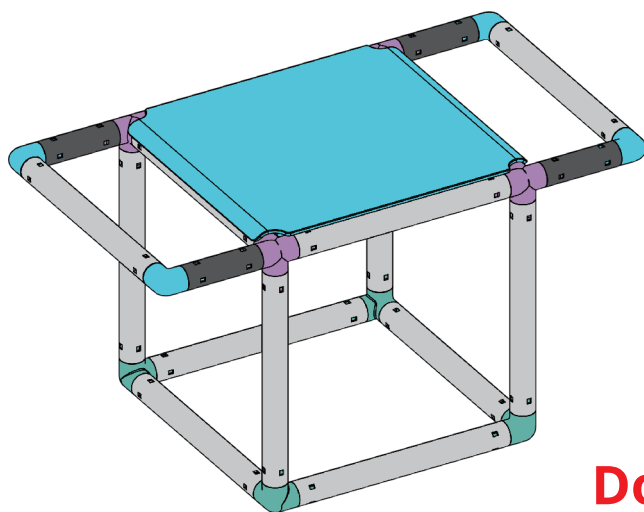
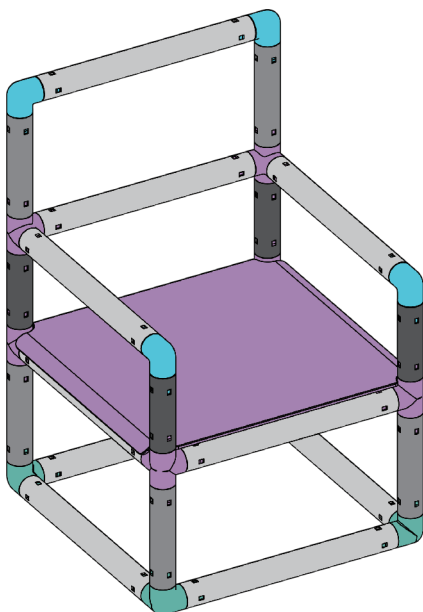

Done

FURNITURE 4

Order of assembly

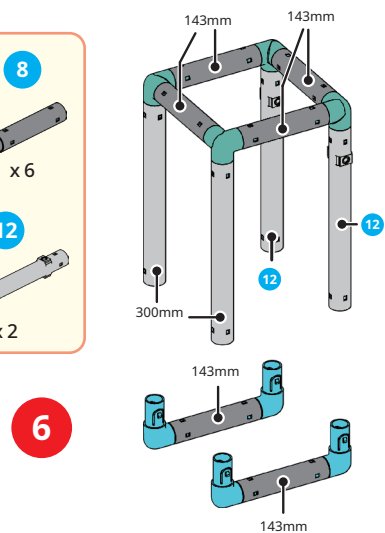
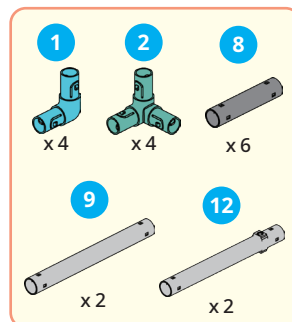
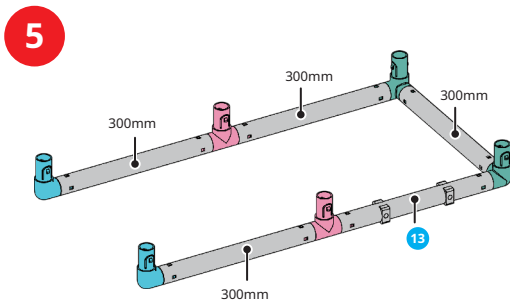
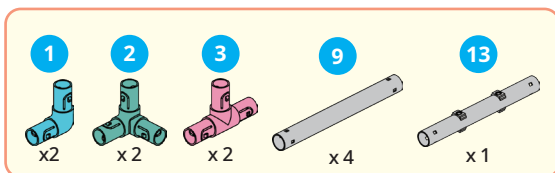
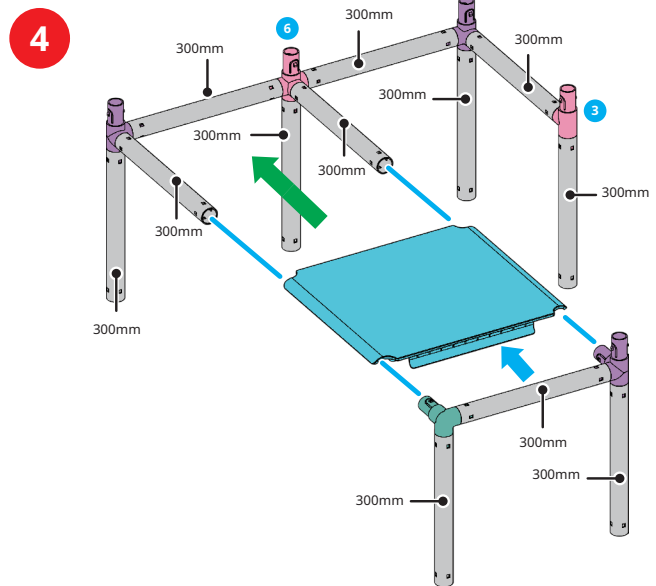
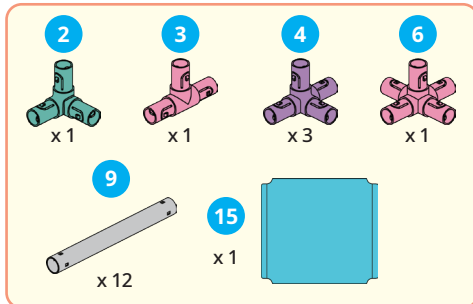
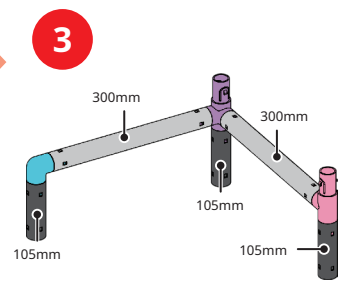
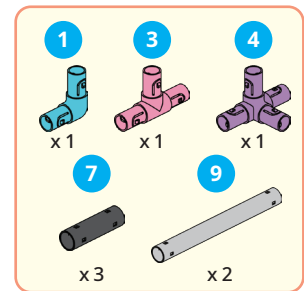
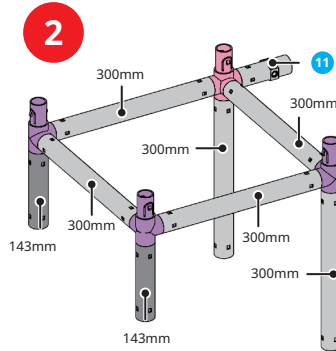
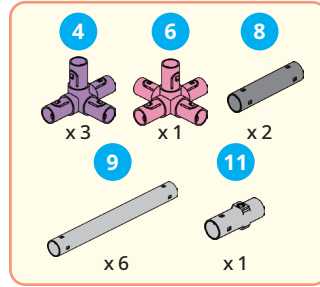
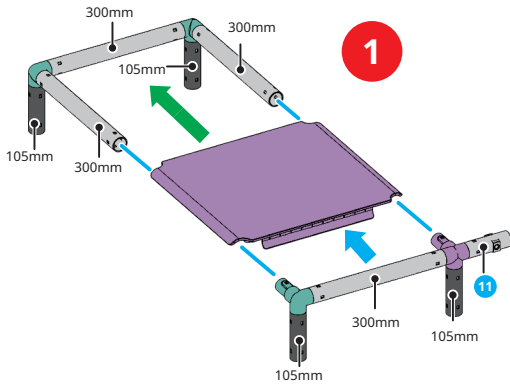
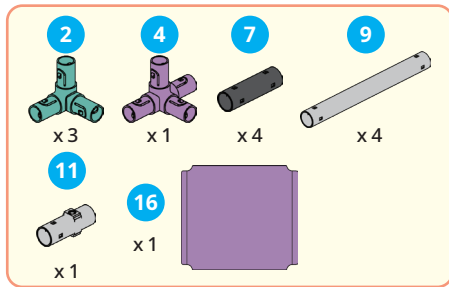

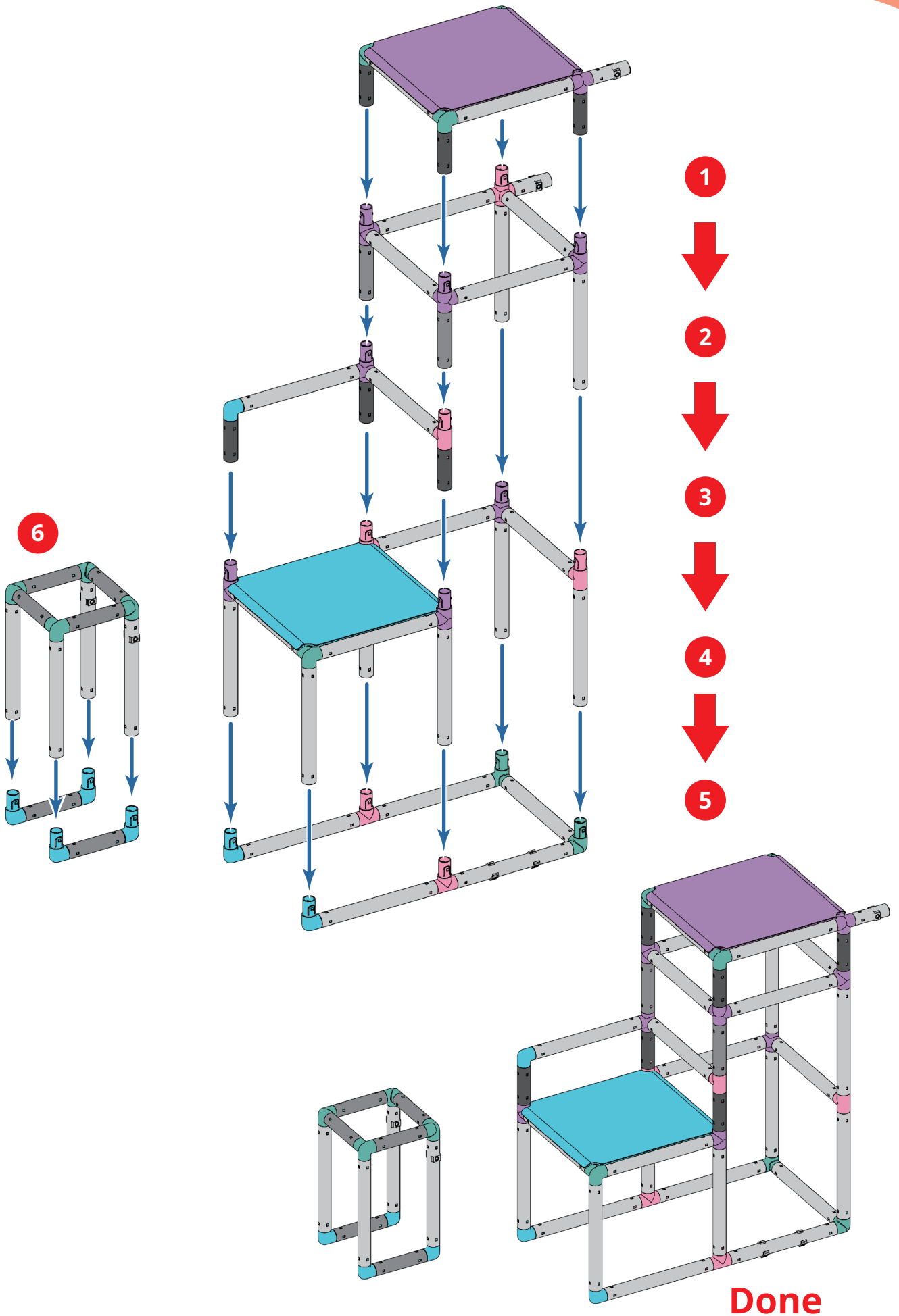



GENIUS TOY TAIWAN CO., LTD.
www.gigotoys.com

© 2022 Genius Toy Taiwan Co., Ltd. ALL RIGHTS RESERVED

R21#1278R